



SOBHA ONE

SOBHA  
REALTY



ONE

THE JOURNEY BEGINS

ONE that brings you  
closer to nature



A place where you can take  
one day at a time



ONE

BE ONESELF

It's one of a kind, like you



BEST THAT LIFE HAS TO OFFER

One where the world is  
close yet far away

# THE POWER OF ONE



*When imagination and vision  
come together Life meets style.*

City and nature hum together,  
Work & play find a balance and become One

# ONE WAY: YOUR WAY

The best places are hidden in plain sight

Near the vital Ras Al Khor Road, Sobha One is a little world tucked away. Look to the north at the calming waters of the Creek as they look back. Further north in the skyline with panoramic views of The Burj Khalifa, Creek Tower to the Northeast and Downtown to the West.



# ARRIVE & DEPART WITH GRACE

Sobha One is right near two new interchanges on Ras Al Khor Road. So, getting home has never been faster. With exits in both the West and East, a new planned metro line behind Sobha One, soar where you need to be on your terms.







# LIVING BY THE WATER

Imagine waking up each morning next to serene water. The sun glints off the water, casting a sparkling path across the ripples. A light breeze blows, rustling the leaves of the nearby trees.

It's yours to stroll down the pathway or sit peacefully watching the calm waters. Go on, spend lazy weekends lounging near the water, reading, and soaking up the sun.



# ONE POINT OF VIEW: YOURS

With a canvas spread over 1.5 million square feet, its breathtaking views as far as your eye can see. Look around to views of Golf Course, calm water, iconic Burj Khalifa & Downtown. Every glance sets a different mood.



# ONE

SPACE

Sobha One spreads its tapestry over five interlinked towers. Rising from 30 stories tall and hitting a crescendo of 65 stories, it's one note after another that sings in chorus with the skyline

With 1 to 4 bedroom apartments & 2 to 4 bedroom Duplex, it's a world of its own.



ONE FOR ALL  
ALL FOR ONE



*Life is too short to settle for anything less than  
the best. At Sobha One, luxury living is a  
natural choice.*

# TEE OFF IN STYLE

The first of its kind in Dubai, a world class Pitch and Putt golf course featuring 18 holes of golf, each meticulously designed.

It is the perfect way to unwind after a long day at work. After all, there's nothing like sinking a long putt on a sun-drenched fairway. The clubhouse is appointed with upscale amenities and a patio overlooking the greens.



# DINE BY THE WATERS

The food & beverage esplanade that borders the calm waters is also a feast for the palate to suit every taste and time.

Spread over almost half a kilometer, it offers fine restaurants for an intimate dinner, quick catch-up over a cup of coffee, or a power lunch.



# SKY GARDEN

Rise high above and look at the stars. Soak in the stunning views of the city. Catch the sun rays when they rise and set. Do it all from the magnificent panoramic sky terrace in each tower





# COURTYARD FOR THE SENSES



*All the 5 Towers at Sobha One have interconnected four themed courtyards. As private outdoor retreats, these lush, landscaped spaces add to the overall aesthetic.*

# RELAX

In a fast-paced world, finding ways to relax is more important than ever. Take a leisurely stroll through the tree avenues, do yoga on the group decks, or stroll in the gardens. And when you need to refuel, enjoy a meal at the BBQ & dining areas or catch a movie under the stars on our cinema screen. There is something for everyone





# REMEMBER

The family courtyard is a great way to spend quality time together. You can pack a picnic lunch and enjoy the beautiful weather. Or spending a day cooling off in the water, splashing with the little ones. So, come on down and make memories with your loved ones!





# RECHARGE

We believe that fitness should be fun! That's why we've created a unique courtyard that combines the best of gyms with exciting new indoor and outdoor features from static bikes, treadmills, circuit training areas and battle ropes. So sweat it out and be the best version of yourself.





# REFRESH

This themed courtyard is the way to do just that after a long day. Step into the pool area, and the stress of daily life melts away. Feel your muscles loosening and your mind clearing as you swim laps. Close your eyes and let the warm sun wash over you, lulling you into a state of relaxation.





SOBHA ONE



FLEXIBLE PAYMENT PLAN

60%

During Construction

40%

On Completion

Grand 1 to 4 Bedroom apartments & 2, 3, 4 Bedroom Duplex

ONE

*awaits you...*

# LOCATION MAP



Sheikh Zayed Road

Burj Khalifa & Downtown Dubai

Business Bay

The Dubai Mall

Dubai Canal

The Dubai Frame

Sobha Hartland & 2 International Schools

Dubai International Airport

Ras Al Khair Wildlife Sanctuary

Dubai Creek

SOBHA ONE

Golf Course

Ras Al Khair Road



RAS AL KHOR  
WILDLIFE SANCTUARY  
05 MINUTES



MEYDAN  
RACE COURSE  
10 MINUTES



SOBHA HARTLAND &  
2 INTERNATIONAL SCHOOLS  
10 MINUTES



DUBAI INTERNATIONAL  
AIRPORT  
12 MINUTES



BUSINESS BAY  
12 MINUTES



THE DUBAI MALL  
15 MINUTES



BURJ KHALIFA &  
DOWNTOWN DUBAI  
15 MINUTES



DUBAI FRAME  
15 MINUTES



DUBAI OPERA  
15 MINUTES



PALM JUMERIAH  
25 MINUTES



# MASTER PLAN

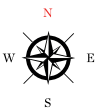

# GROUND FLOOR

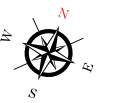
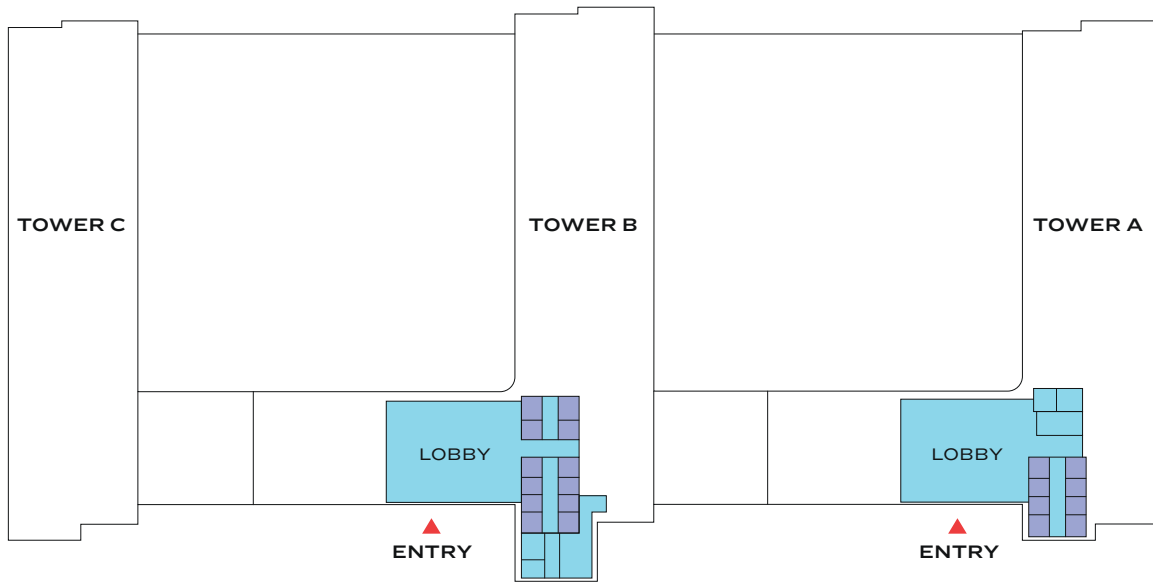

**TOWER A**  
**FLOOR PLAN LAYOUTS**

# FLOOR PLAN LAYOUT

## TOWER A

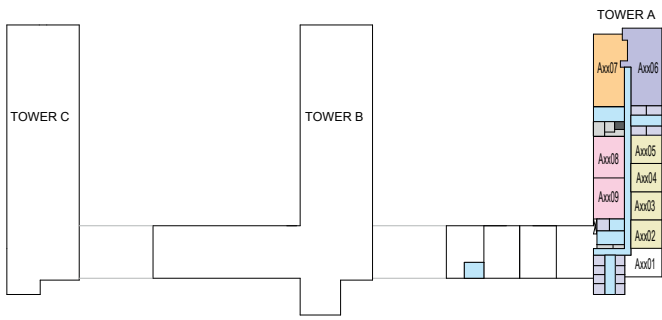
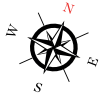

LEVEL 08,11,20,23,32,35,44,47  
UPPER LEVEL

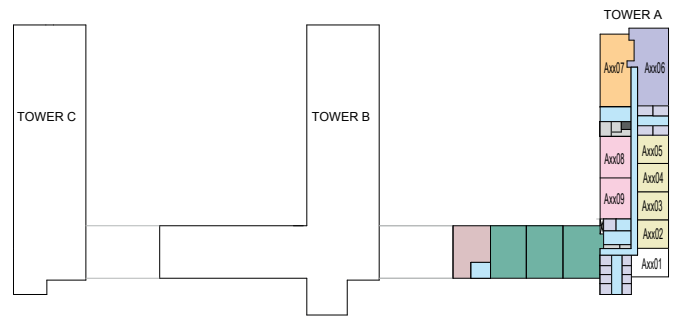

LEVEL 09,21,33,45  
LOWER LEVEL

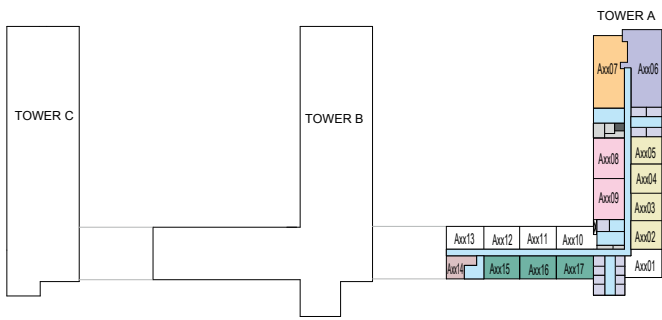

LEVEL 07,10,19,22,31,34,43,46  
ACCESS LEVEL

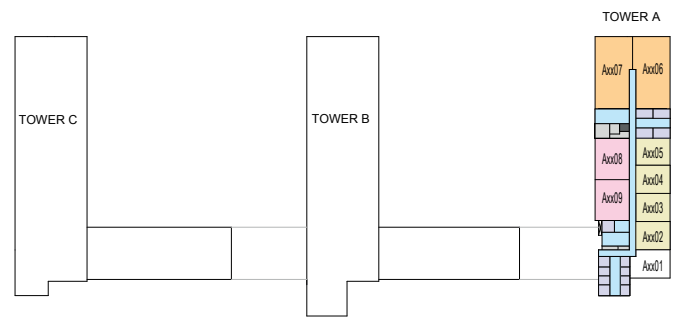

LEVEL 12,24,36,48

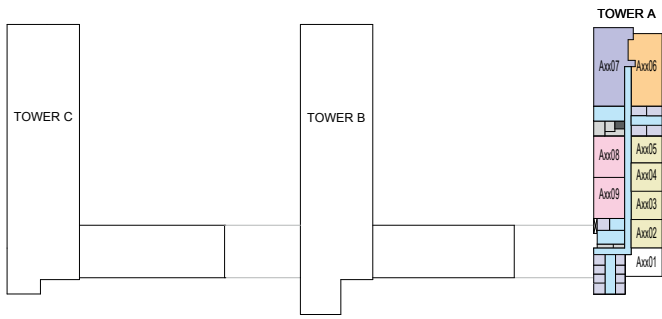

LEVEL 13,37

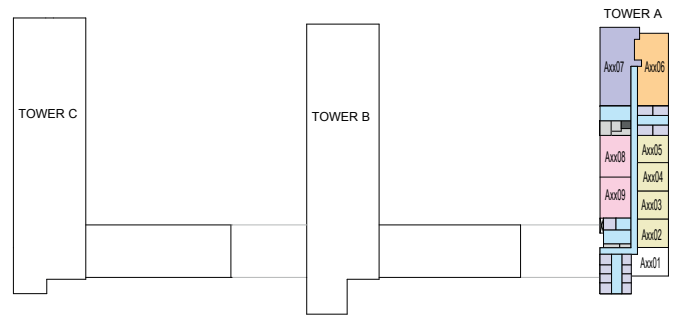

LEVEL 14-17,27-29,38-41

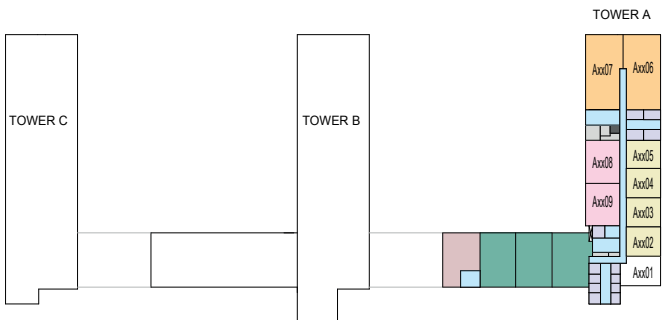

LEVEL 18,30,42  
LOWER LEVEL

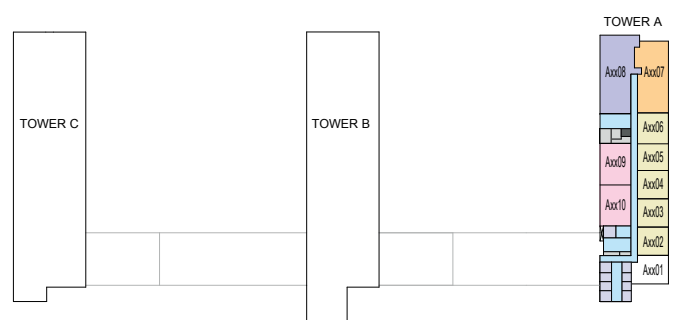

LEVEL 51-53

- 1 BED UNIT
- 3 BED UNIT
- 2 BED DUPLEX UNIT
- 4 BED DUPLEX UNIT
- LOBBIES, CORRIDORS & STAIRS
- LIFTS
- 2 BED UNIT
- 4 BED UNIT
- 3 BED DUPLEX UNIT
- SERVICES
- GARBAGE ROOM

Disclaimer: 1. All dimensions are in metric, measured to wall finishes. 2. All materials, dimensions & drawings are approximate. 3. Information is subject to change without notice, at developer's absolute discretion. 4. Actual area may vary from the stated area. 5. Drawing are not to scale. 6. All images used are for illustrative purpose only and do not represent the actual size, features, specifications, fittings and furnishings. 7. The developer reserves the right to make revisions/ alterations, at its absolute discretion, without any liability whatsoever.

# FLOOR PLAN LAYOUT

## TOWER A

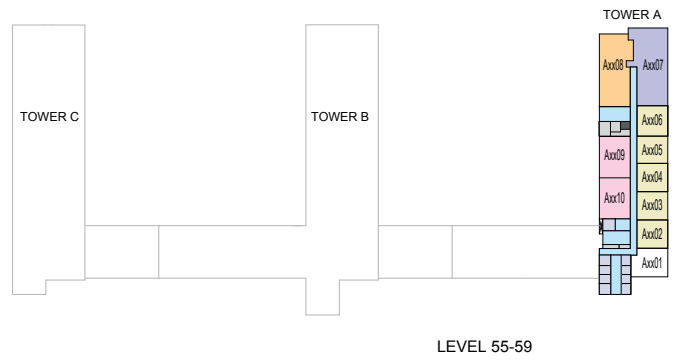
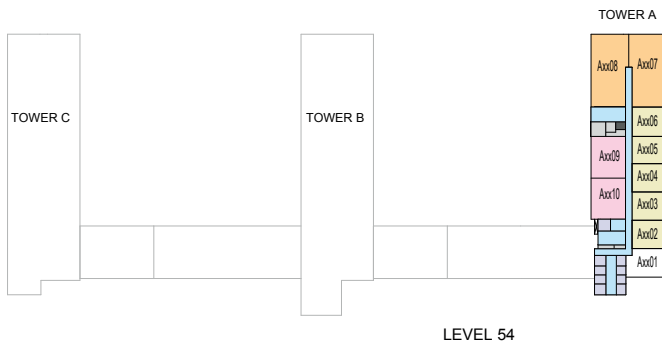
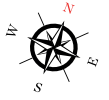

- |   |   |  |  |  |  |
|---|---|--|--|--|--|
| <span style="display: inline-block; width: 15px; height: 15px; background-color: #d9ead3; border: 1px solid black; margin-right: 5px;"></span> 1 BED UNIT | <span style="display: inline-block; width: 15px; height: 15px; background-color: #f4cccc; border: 1px solid black; margin-right: 5px;"></span> 3 BED UNIT | <span style="display: inline-block; width: 15px; height: 15px; background-color: #e6f2ff; border: 1px solid black; margin-right: 5px;"></span> 2 BED DUPLEX UNIT | <span style="display: inline-block; width: 15px; height: 15px; background-color: #cfe2f3; border: 1px solid black; margin-right: 5px;"></span> 4 BED DUPLEX UNIT | <span style="display: inline-block; width: 15px; height: 15px; background-color: #fce4d6; border: 1px solid black; margin-right: 5px;"></span> LOBBIES, CORRIDORS & STAIRS | <span style="display: inline-block; width: 15px; height: 15px; background-color: #d9ead3; border: 1px solid black; margin-right: 5px;"></span> LIFTS |
| <span style="display: inline-block; width: 15px; height: 15px; background-color: #f4cccc; border: 1px solid black; margin-right: 5px;"></span> 2 BED UNIT | <span style="display: inline-block; width: 15px; height: 15px; background-color: #d9ead3; border: 1px solid black; margin-right: 5px;"></span> 4 BED UNIT | <span style="display: inline-block; width: 15px; height: 15px; background-color: #cfe2f3; border: 1px solid black; margin-right: 5px;"></span> 3 BED DUPLEX UNIT | <span style="display: inline-block; width: 15px; height: 15px; background-color: #fce4d6; border: 1px solid black; margin-right: 5px;"></span> SERVICES          | <span style="display: inline-block; width: 15px; height: 15px; background-color: #f4cccc; border: 1px solid black; margin-right: 5px;"></span> GARBAGE ROOM                |  |

Disclaimer: 1. All dimensions are in metric, measured to wall finishes. 2. All materials, dimensions & drawings are approximate. 3. Information is subject to change without notice, at developer's absolute discretion. 4. Actual area may vary from the stated area. 5. Drawing are not to scale. 6. All images used are for illustrative purpose only and do not represent the actual size, features, specifications, fittings and furnishings. 7. The developer reserves the right to make revisions/ alterations, at its absolute discretion, without any liability whatsoever.

# TOWER A

UNIT PLAN LAYOUTS

# 1 BEDROOM APARTMENT

## TYPE A (with powder room + balcony)

**TOTAL SALEABLE AREA**

SUITE = 674.79 SQ.FT.

BALCONY = 57.48 SQ.FT.

TOTAL = 732.27 SQ.FT.

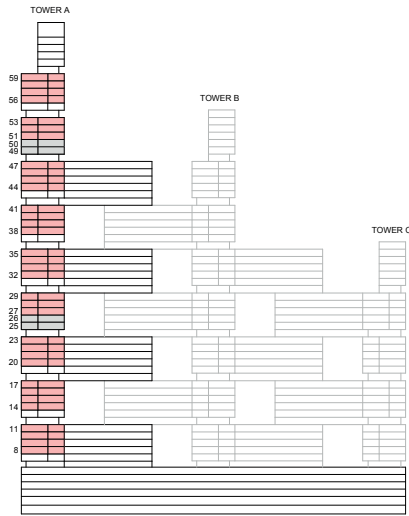

KEY ELEVATION

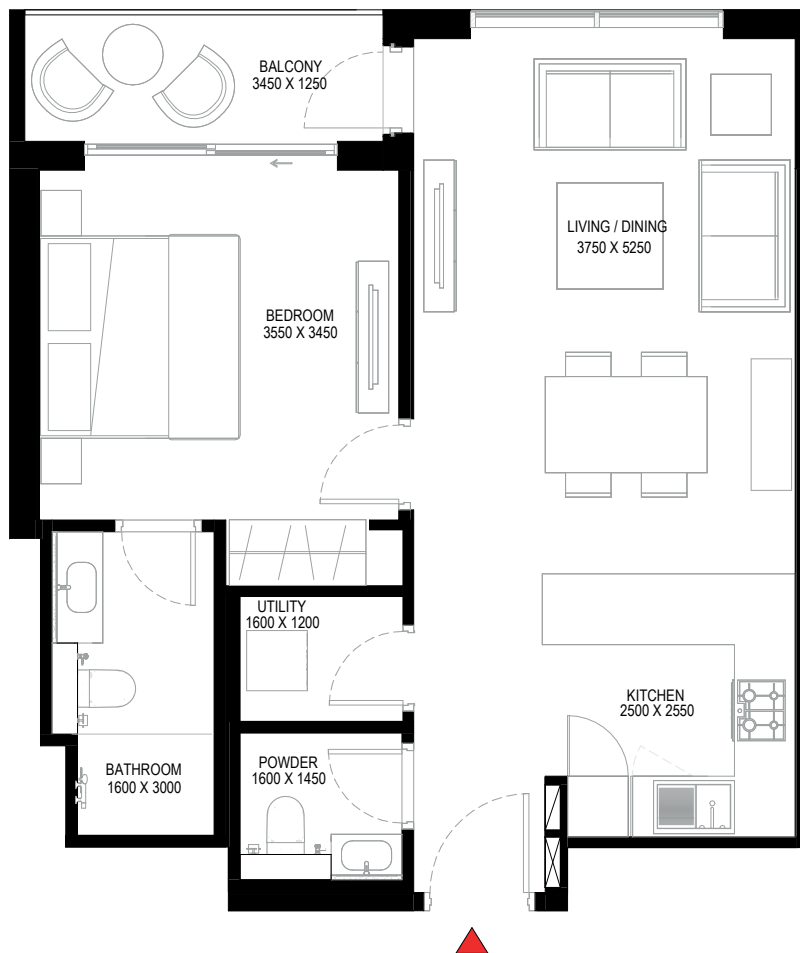
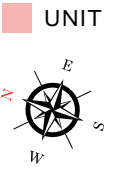

List of unit numbers with this unit plan:

### VIEWS

#### Creek

A802, A804, A902, A904, A1002, A1004, A1102, A1104, A1402, A1404, A1502, A1504, A1602, A1604, A1702, A1704, A2002, A2004, A2102, A2104, A2202, A2204, A2302, A2304, A2702, A2704, A2802, A2804, A2902, A2904, A3202, A3204, A3302, A3304, A3402, A3404, A3502, A3504, A3802, A3804, A3902, A3904, A4002, A4004, A4102, A4104, A4402, A4404, A4502, A4504, A4602, A4604, A4702, A4704, A5102, A5104, A5106, A5202, A5204, A5206, A5302, A5304, A5306, A5602, A5604, A5606, A5702, A5704, A5706, A5802, A5804, A5806, A5902, A5904, A5906

Disclaimer: 1. All dimensions are in metric, measured to wall finishes. 2. All materials, dimensions & drawings are approximate. 3. Information is subject to change without notice, at developer's absolute discretion. 4. Actual area may vary from the stated area. 5. Drawing are not to scale. 6. All images used are for illustrative purpose only and do not represent the actual size, features, specifications, fittings and furnishings. 7. The developer reserves the right to make revisions/ alterations, at its absolute discretion, without any liability whatsoever.

# 1 BEDROOM APARTMENT

## TYPE A (with powder room + balcony)

**TOTAL SALEABLE AREA**

SUITE = 674.79 SQ.FT.

BALCONY = 57.48 SQ.FT.

TOTAL = 732.27 SQ.FT.

 UNIT

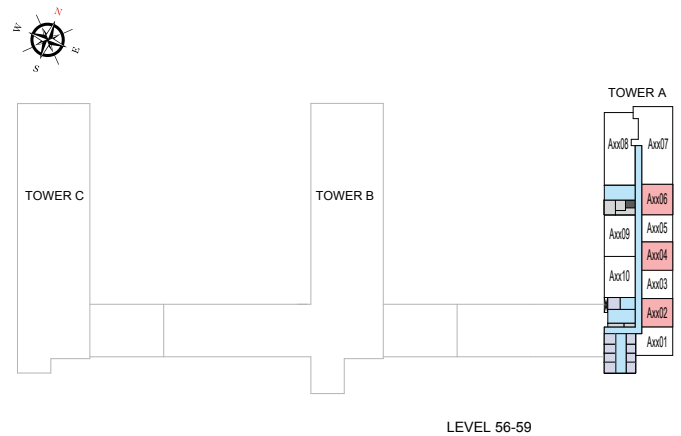
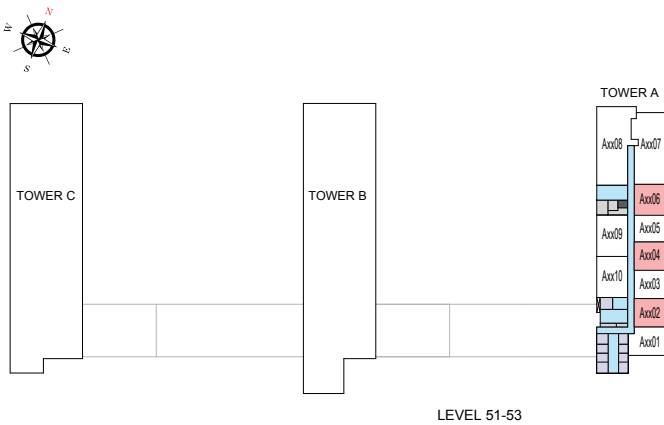
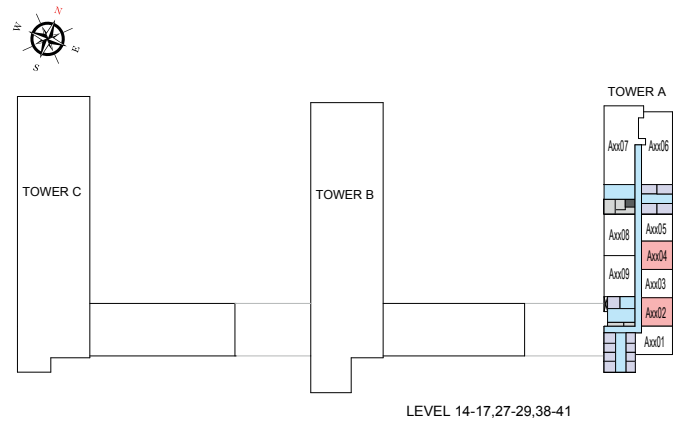
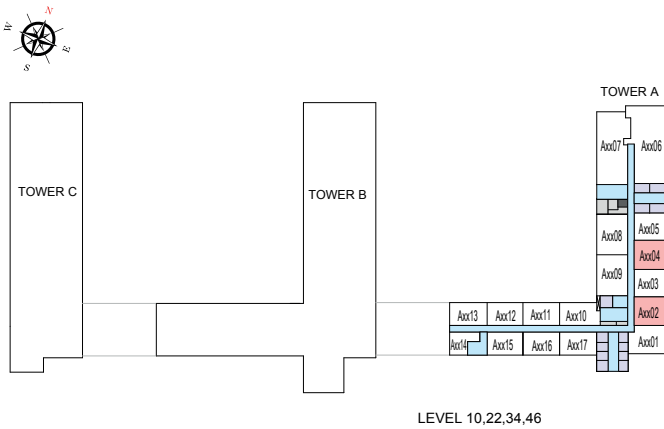
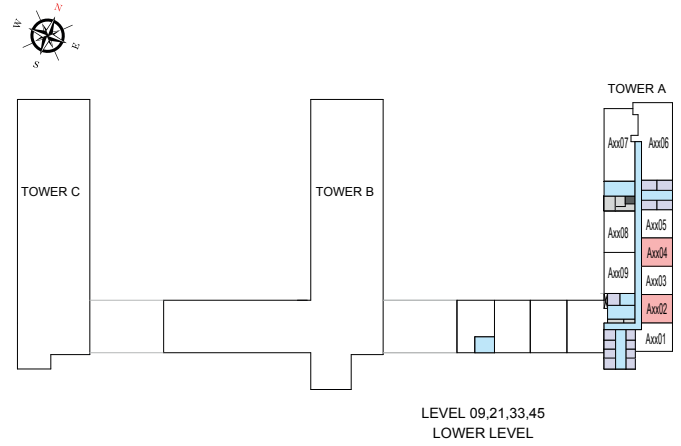
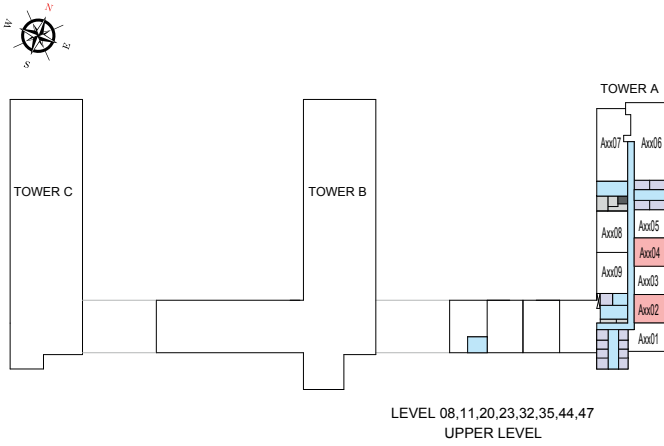

List of unit numbers with this unit plan:

## VIEWS

### Creek

A802, A804, A902, A904, A1002, A1004, A1102, A1104, A1402, A1404, A1502, A1504, A1602, A1604, A1702, A1704, A2002, A2004, A2102, A2104, A2202, A2204, A2302, A2304, A2702, A2704, A2802, A2804, A2902, A2904, A3202, A3204, A3302, A3304, A3402, A3404, A3502, A3504, A3802, A3804, A3902, A3904, A4002, A4004, A4102, A4104, A4402, A4404, A4502, A4504, A4602, A4604, A4702, A4704, A5102, A5104, A5106, A5202, A5204, A5206, A5302, A5304, A5306, A5602, A5604, A5606, A5702, A5704, A5706, A5802, A5804, A5806, A5902, A5904, A5906

Disclaimer: 1. All dimensions are in metric, measured to wall finishes. 2. All materials, dimensions & drawings are approximate. 3. Information is subject to change without notice, at developer's absolute discretion. 4. Actual area may vary from the stated area. 5. Drawing are not to scale. 6. All images used are for illustrative purpose only and do not represent the actual size, features, specifications, fittings and furnishings. 7. The developer reserves the right to make revisions/ alterations, at its absolute discretion, without any liability whatsoever.



# 1 BEDROOM APARTMENT

TYPE A (with powder room + balcony) VARIANT 1

**TOTAL SALEABLE AREA**

SUITE = 674.79 SQ.FT.

BALCONY = 57.48 SQ.FT.

TOTAL = 732.27 SQ.FT.

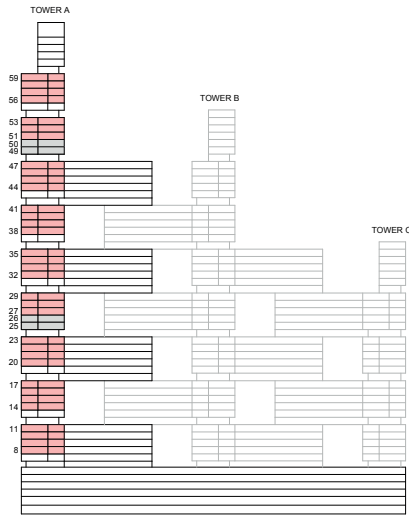

KEY ELEVATION

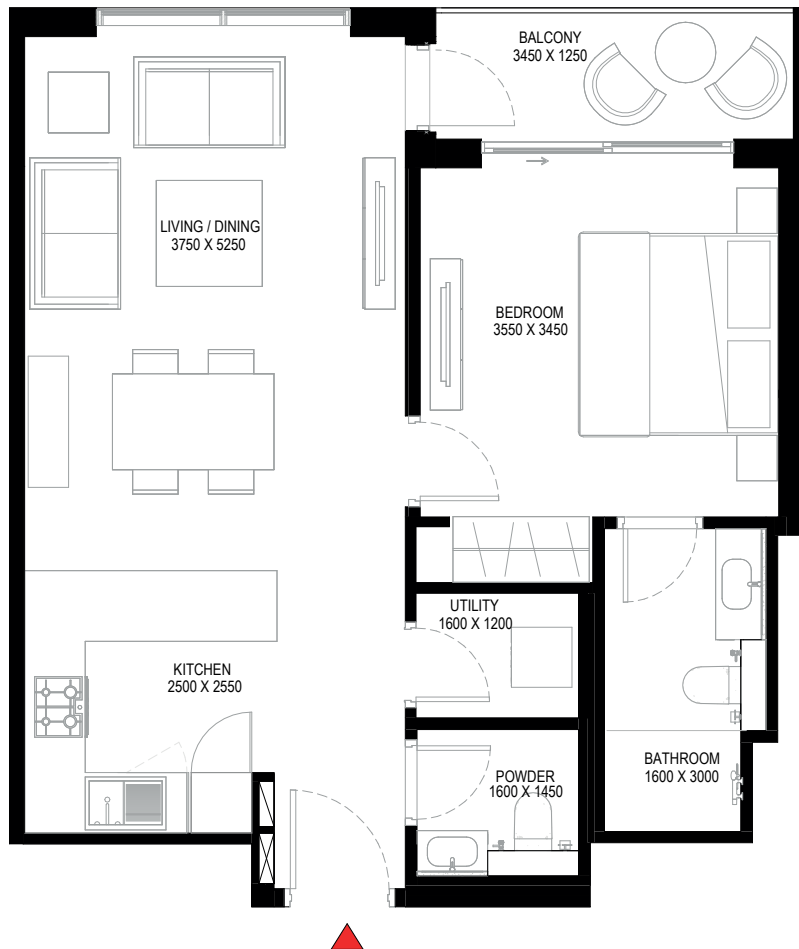
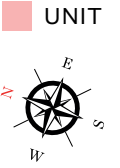

List of unit numbers with this unit plan:

## VIEWS

### Creek

A803, A805, A903, A905, A1003, A1005, A1103, A1105, A1403, A1405, A1503, A1505, A1603, A1605, A1703, A1705, A2003, A2005, A2103, A2105, A2203, A2205, A2303, A2305, A2703, A2705, A2803, A2805, A2903, A2905, A3203, A3205, A3303, A3305, A3403, A3405, A3503, A3505, A3803, A3805, A3903, A3905, A4003, A4005, A4103, A4105, A4403, A4405, A4503, A4505, A4603, A4605, A4703, A4705, A5103, A5105, A5203, A5205, A5303, A5305, A5603, A5605, A5703, A5705, A5803, A5805, A5903, A5905

Disclaimer: 1. All dimensions are in metric, measured to wall finishes. 2. All materials, dimensions & drawings are approximate. 3. Information is subject to change without notice, at developer's absolute discretion. 4. Actual area may vary from the stated area. 5. Drawing are not to scale. 6. All images used are for illustrative purpose only and do not represent the actual size, features, specifications, fittings and furnishings. 7. The developer reserves the right to make revisions/ alterations, at its absolute discretion, without any liability whatsoever.

# 1 BEDROOM APARTMENT

TYPE A (with powder room + balcony) VARIANT 1

**TOTAL SALEABLE AREA**

SUITE = 674.79 SQ.FT.

BALCONY = 57.48 SQ.FT.

TOTAL = 732.27 SQ.FT.

 UNIT

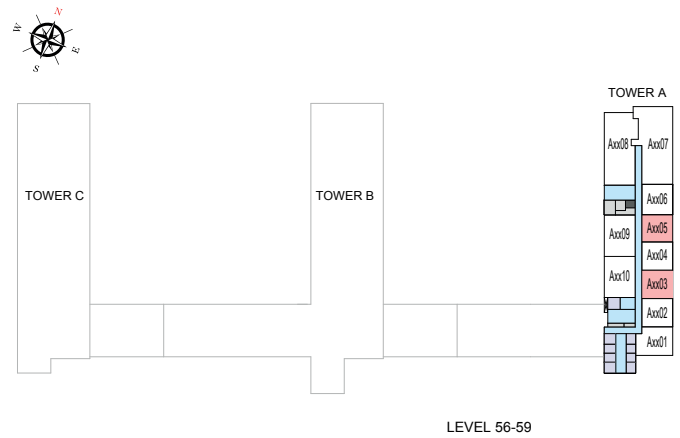
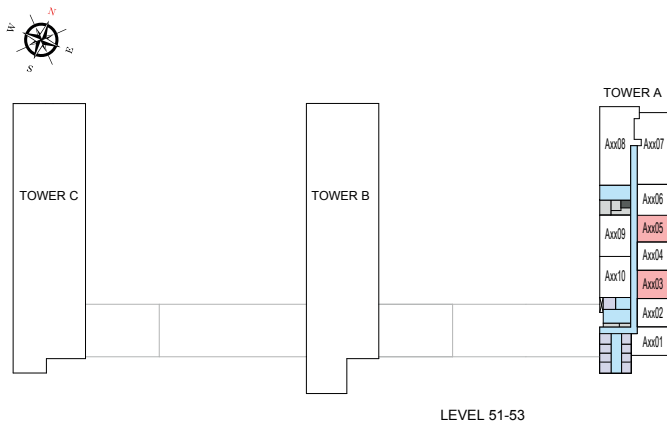
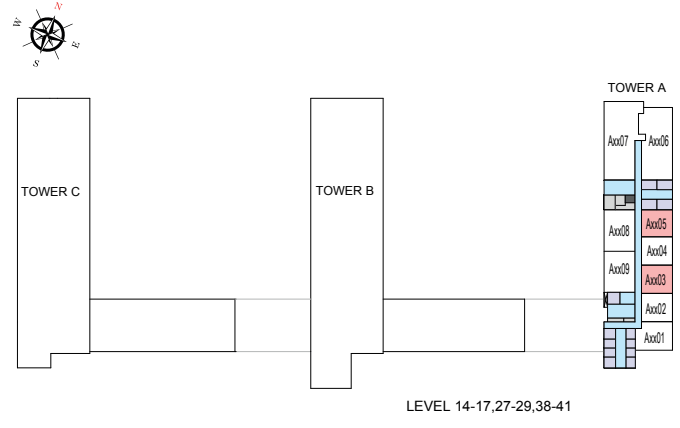
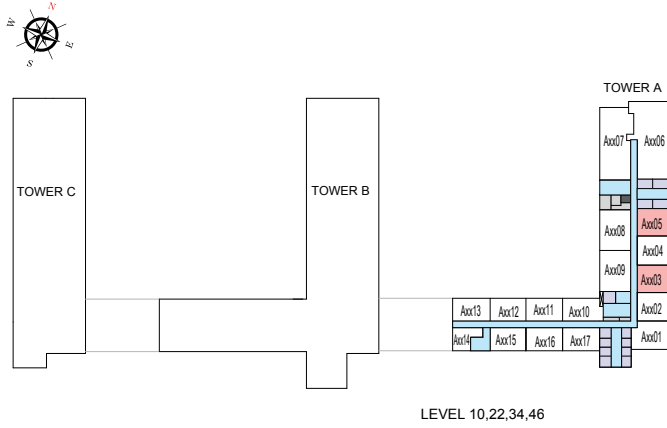
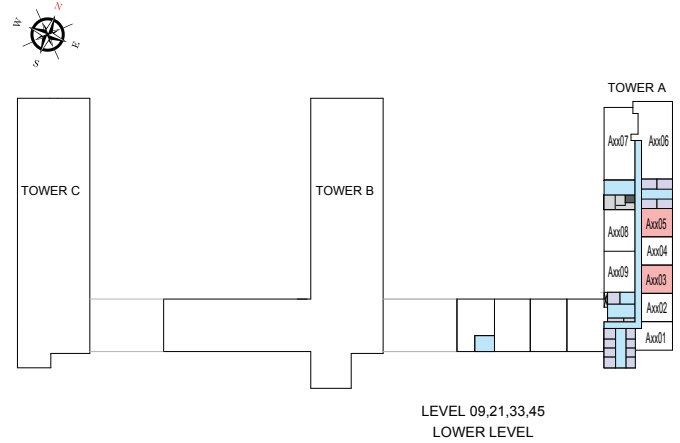
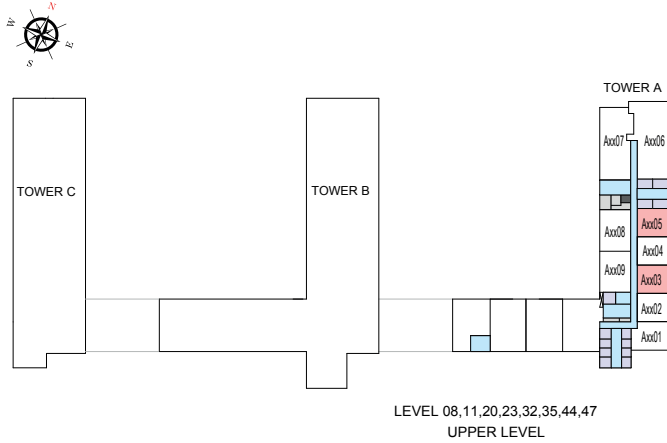

List of unit numbers with this unit plan:

## VIEWS

### Creek

A803, A805, A903, A905, A1003, A1005, A1103, A1105, A1403, A1405, A1503, A1505, A1603, A1605, A1703, A1705, A2003, A2005, A2103, A2105, A2203, A2205, A2303, A2305, A2703, A2705, A2803, A2805, A2903, A2905, A3203, A3205, A3303, A3305, A3403, A3405, A3503, A3505, A3803, A3805, A3903, A3905, A4003, A4005, A4103, A4105, A4403, A4405, A4503, A4505, A4603, A4605, A4703, A4705, A5103, A5105, A5203, A5205, A5303, A5305, A5603, A5605, A5703, A5705, A5803, A5805, A5903, A5905

Disclaimer: 1. All dimensions are in metric, measured to wall finishes. 2. All materials, dimensions & drawings are approximate. 3. Information is subject to change without notice, at developer's absolute discretion. 4. Actual area may vary from the stated area. 5. Drawing are not to scale. 6. All images used are for illustrative purpose only and do not represent the actual size, features, specifications, fittings and furnishings. 7. The developer reserves the right to make revisions/ alterations, at its absolute discretion, without any liability whatsoever.

# 1 BEDROOM APARTMENT

TYPE B (with powder room + yard)

**TOTAL SALEABLE AREA**

SUITE = 675.11 SQ.FT.

YARD = 132.72 SQ.FT.

TOTAL = 807.83 SQ.FT.

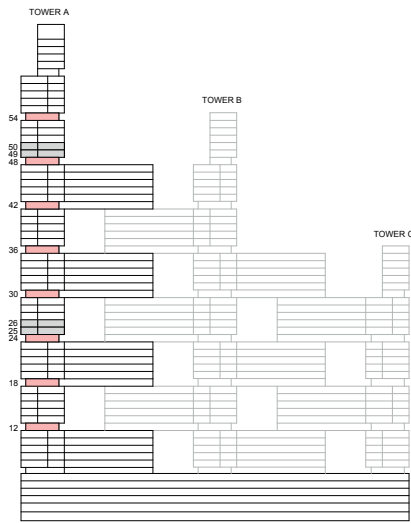

KEY ELEVATION

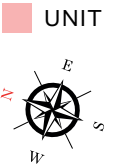

List of unit numbers with this unit plan:

## VIEWS

Creek

A1202, A1204, A1802, A1804, A2402, A2404, A3002, A3004, A3602, A3604, A4202, A4204, A4802, A4804, A5402, A5404, A5406

Disclaimer: 1. All dimensions are in metric, measured to wall finishes. 2. All materials, dimensions & drawings are approximate. 3. Information is subject to change without notice, at developer's absolute discretion. 4. Actual area may vary from the stated area. 5. Drawing are not to scale. 6. All images used are for illustrative purpose only and do not represent the actual size, features, specifications, fittings and furnishings. 7. The developer reserves the right to make revisions/ alterations, at its absolute discretion, without any liability whatsoever.

# 1 BEDROOM APARTMENT

TYPE B (with powder room + yard)

## TOTAL SALEABLE AREA

SUITE = 675.11 SQ.FT.

YARD = 132.72 SQ.FT.

TOTAL = 807.83 SQ.FT.

■ UNIT

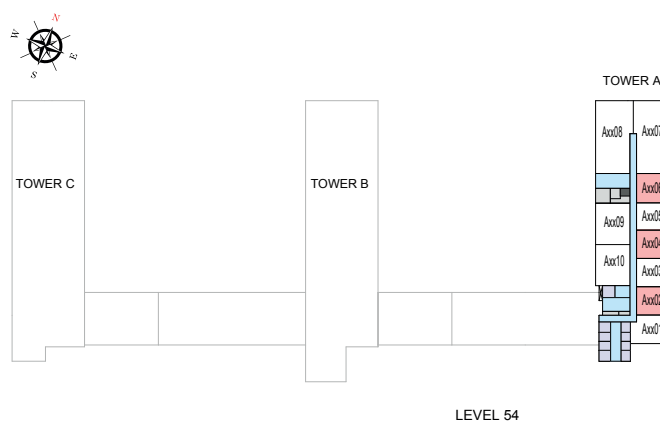
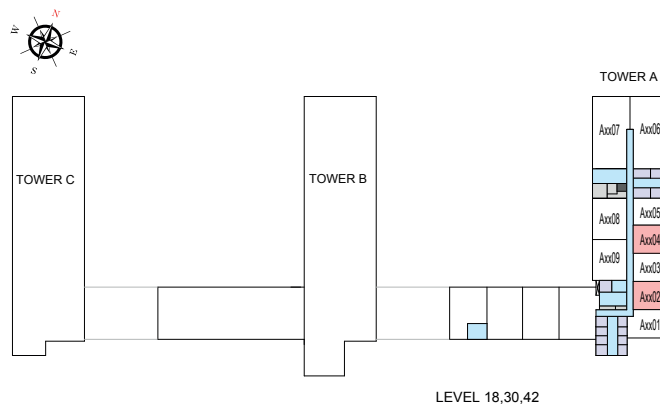
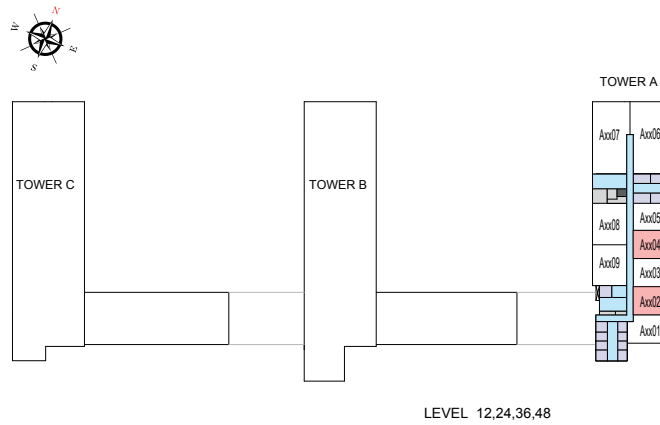

List of unit numbers with this unit plan:

## VIEWS

Creek

A1202, A1204, A1802, A1804, A2402, A2404, A3002, A3004, A3602, A3604, A4202, A4204, A4802, A4804, A5402, A5404, A5406

Disclaimer: 1. All dimensions are in metric, measured to wall finishes. 2. All materials, dimensions & drawings are approximate. 3. Information is subject to change without notice, at developer's absolute discretion. 4. Actual area may vary from the stated area. 5. Drawing are not to scale. 6. All images used are for illustrative purpose only and do not represent the actual size, features, specifications, fittings and furnishings. 7. The developer reserves the right to make revisions/ alterations, at its absolute discretion, without any liability whatsoever.

# 1 BEDROOM APARTMENT

TYPE B (with powder room + yard) VARIANT 1

**TOTAL SALEABLE AREA**

SUITE = 675.11 SQ.FT.

YARD = 132.72 SQ.FT.

TOTAL = 807.83 SQ.FT.

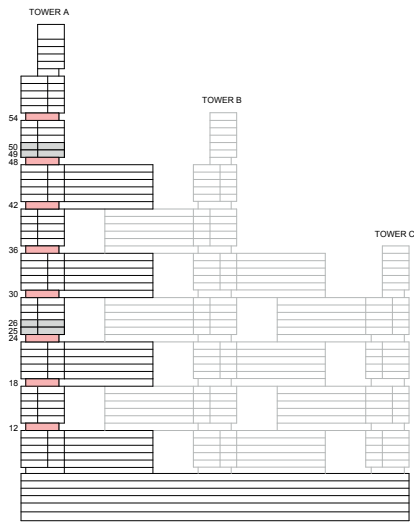

KEY ELEVATION

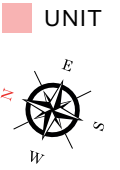

List of unit numbers with this unit plan:

## VIEWS

Creek

A1203, A1205, A1803, A1805, A2403, A2405, A3003, A3005, A3603, A3605, A4203, A4205, A4803, A4805, A5403, A5405

Disclaimer: 1. All dimensions are in metric, measured to wall finishes. 2. All materials, dimensions & drawings are approximate. 3. Information is subject to change without notice, at developer's absolute discretion. 4. Actual area may vary from the stated area. 5. Drawing are not to scale. 6. All images used are for illustrative purpose only and do not represent the actual size, features, specifications, fittings and furnishings. 7. The developer reserves the right to make revisions/ alterations, at its absolute discretion, without any liability whatsoever.

# 1 BEDROOM APARTMENT

TYPE B (with powder room + yard) VARIANT 1

**TOTAL SALEABLE AREA**

SUITE = 675.11 SQ.FT.

YARD = 132.72 SQ.FT.

TOTAL = 807.83 SQ.FT.

■ UNIT

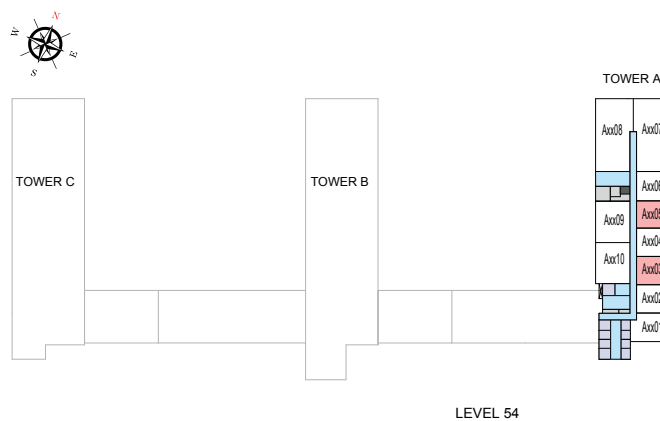
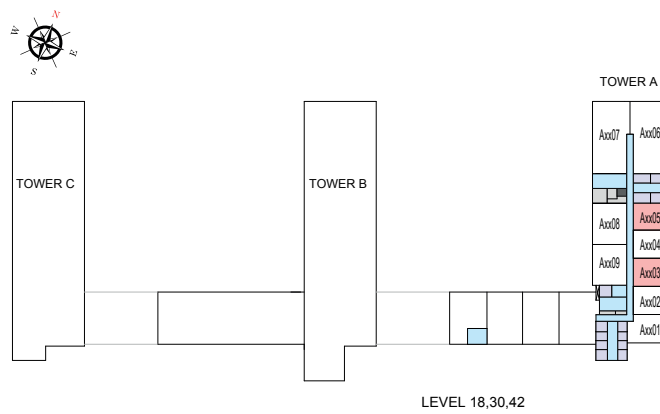
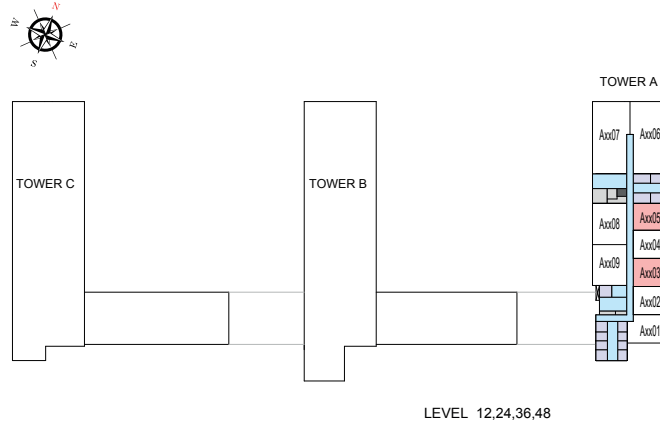

List of unit numbers with this unit plan:

## VIEWS

Creek

A1203, A1205, A1803, A1805, A2403, A2405, A3003, A3005, A3603, A3605, A4203, A4205, A4803, A4805, A5403, A5405

Disclaimer: 1. All dimensions are in metric, measured to wall finishes. 2. All materials, dimensions & drawings are approximate. 3. Information is subject to change without notice, at developer's absolute discretion. 4. Actual area may vary from the stated area. 5. Drawing are not to scale. 6. All images used are for illustrative purpose only and do not represent the actual size, features, specifications, fittings and furnishings. 7. The developer reserves the right to make revisions/ alterations, at its absolute discretion, without any liability whatsoever.

# 1 BEDROOM APARTMENT

TYPE C (with powder room + yard)

## TOTAL SALEABLE AREA

SUITE = 674.79 SQ.FT.

YARD = 133.04 SQ.FT.

TOTAL = 807.83 SQ.FT.

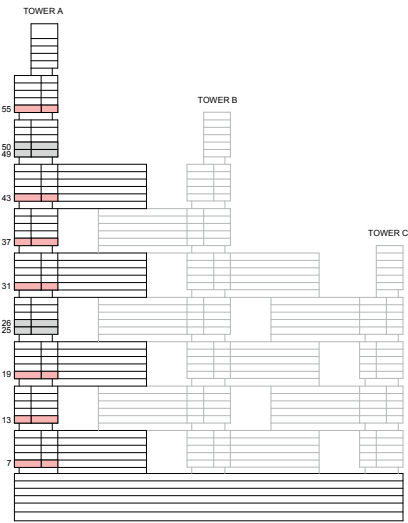

KEY ELEVATION

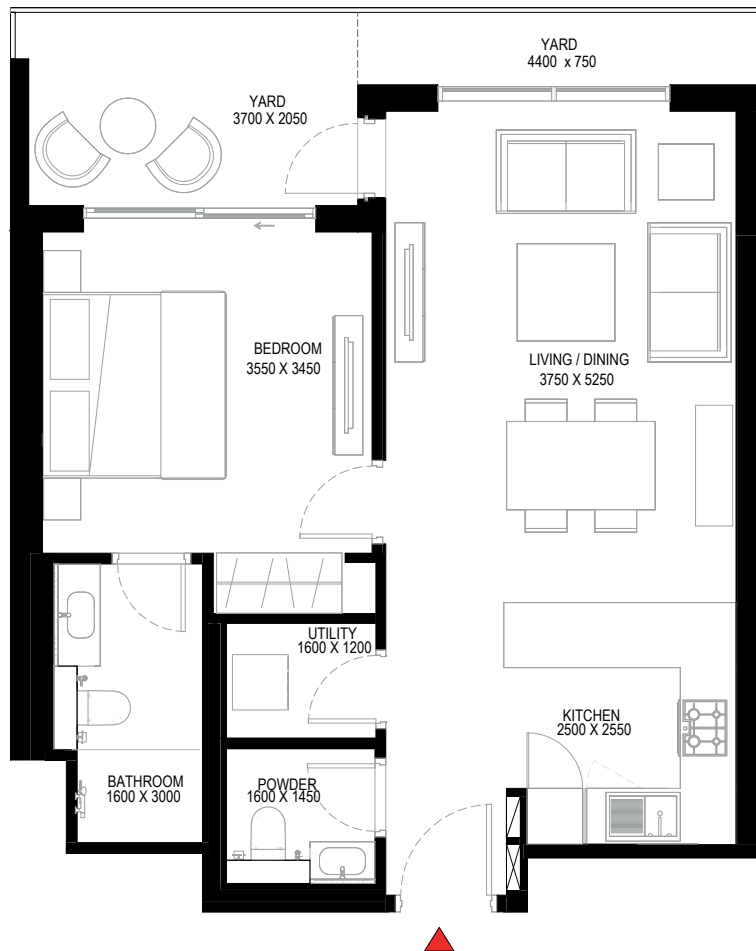
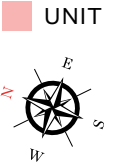

List of unit numbers with this unit plan:

## VIEWS

Creek

A702, A704, A1302, A1304, A1902, A1904, A3102, A3104, A3702, A3704, A4302, A4304, A5502, A5504, A5506

Disclaimer: 1. All dimensions are in metric, measured to wall finishes. 2. All materials, dimensions & drawings are approximate. 3. Information is subject to change without notice, at developer's absolute discretion. 4. Actual area may vary from the stated area. 5. Drawing are not to scale. 6. All images used are for illustrative purpose only and do not represent the actual size, features, specifications, fittings and furnishings. 7. The developer reserves the right to make revisions/ alterations, at its absolute discretion, without any liability whatsoever.

# 1 BEDROOM APARTMENT

TYPE C (with powder room + yard)

## TOTAL SALEABLE AREA

SUITE = 674.79 SQ.FT.

YARD = 133.04 SQ.FT.

TOTAL = 807.83 SQ.FT.

■ UNIT

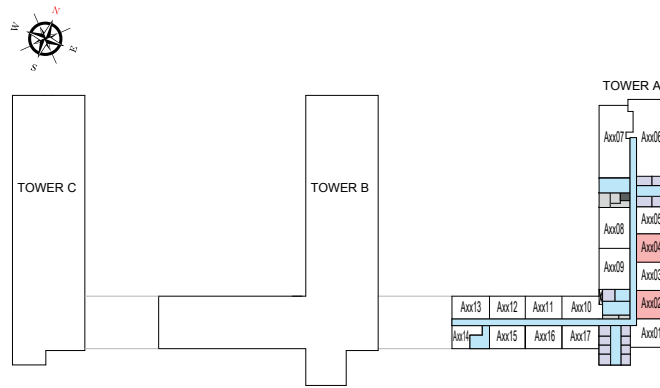

LEVEL 07,19,31,43  
ACCESS LEVEL

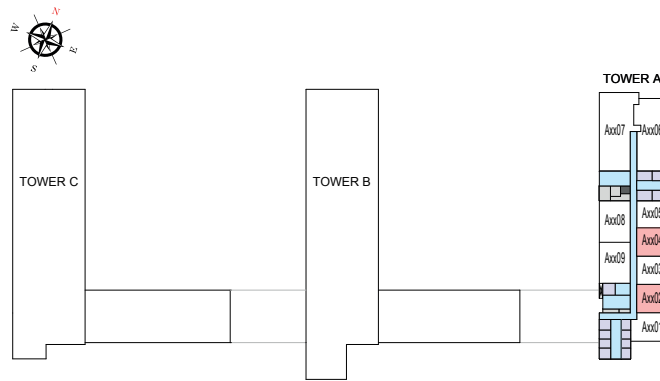

LEVEL 13,37

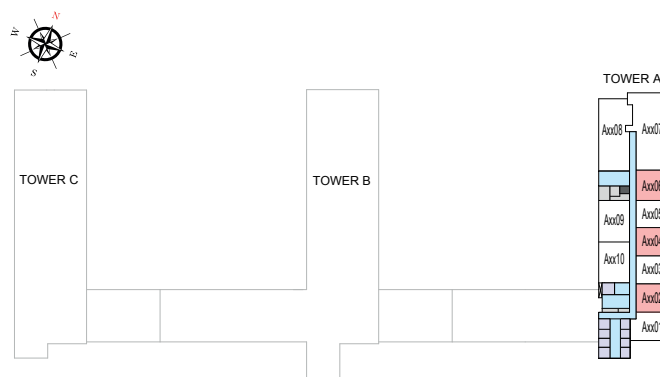

LEVEL 55

List of unit numbers with this unit plan:

## VIEWS

Creek

A702, A704, A1302, A1304, A1902, A1904, A3102, A3104, A3702, A3704, A4302, A4304, A5502, A5504, A5506

Disclaimer: 1. All dimensions are in metric, measured to wall finishes. 2. All materials, dimensions & drawings are approximate. 3. Information is subject to change without notice, at developer's absolute discretion. 4. Actual area may vary from the stated area. 5. Drawing are not to scale. 6. All images used are for illustrative purpose only and do not represent the actual size, features, specifications, fittings and furnishings. 7. The developer reserves the right to make revisions/ alterations, at its absolute discretion, without any liability whatsoever.



# 1 BEDROOM APARTMENT

TYPE C (with powder room + yard) VARIANT 1

**TOTAL SALEABLE AREA**

SUITE = 674.79 SQ.FT.

YARD = 133.04 SQ.FT.

TOTAL = 807.83 SQ.FT.

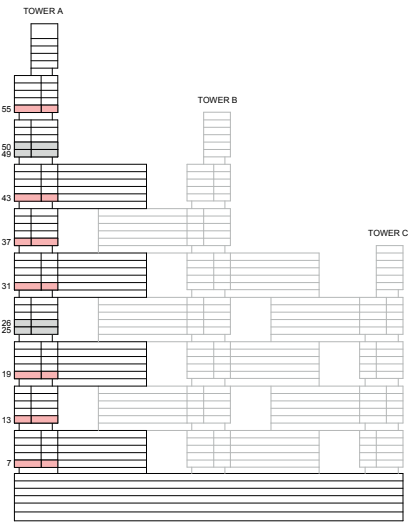

KEY ELEVATION

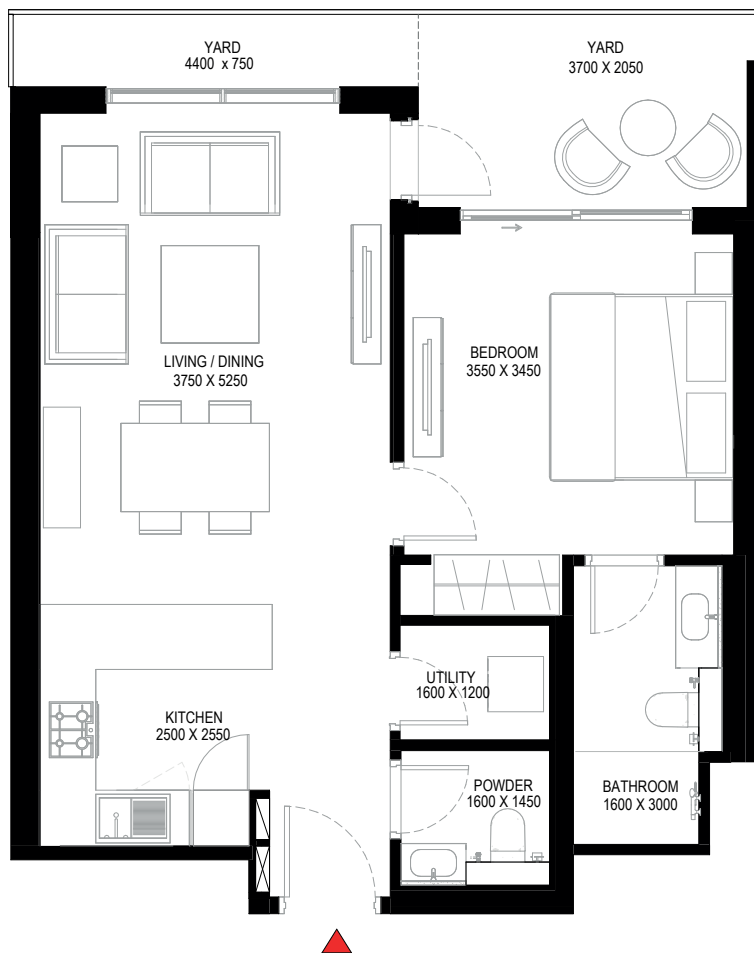
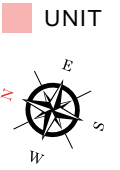

List of unit numbers with this unit plan:

## VIEWS

Creek

A703, A705, A1303, A1305, A1903, A1905, A3103, A3105, A3703, A3705, A4303, A4305, A5503, A5505

Disclaimer: 1. All dimensions are in metric, measured to wall finishes. 2. All materials, dimensions & drawings are approximate. 3. Information is subject to change without notice, at developer's absolute discretion. 4. Actual area may vary from the stated area. 5. Drawing are not to scale. 6. All images used are for illustrative purpose only and do not represent the actual size, features, specifications, fittings and furnishings. 7. The developer reserves the right to make revisions/ alterations, at its absolute discretion, without any liability whatsoever.

# 1 BEDROOM APARTMENT

TYPE C (with powder room + yard) VARIANT 1

## TOTAL SALEABLE AREA

SUITE = 674.79 SQ.FT.

YARD = 133.04 SQ.FT.

TOTAL = 807.83 SQ.FT.

■ UNIT

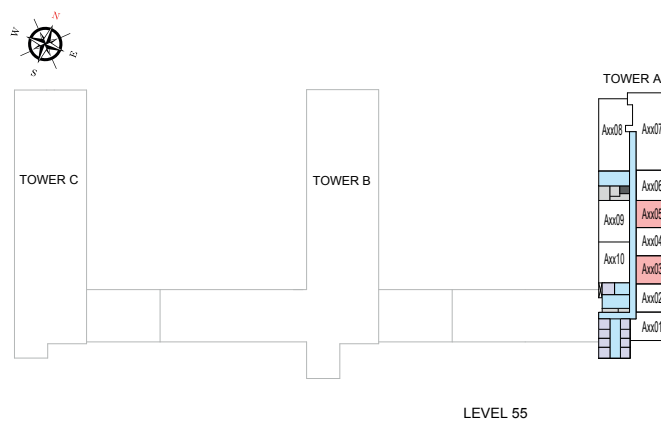
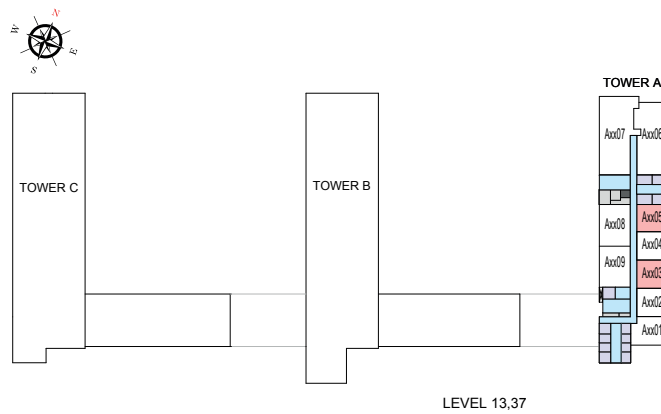
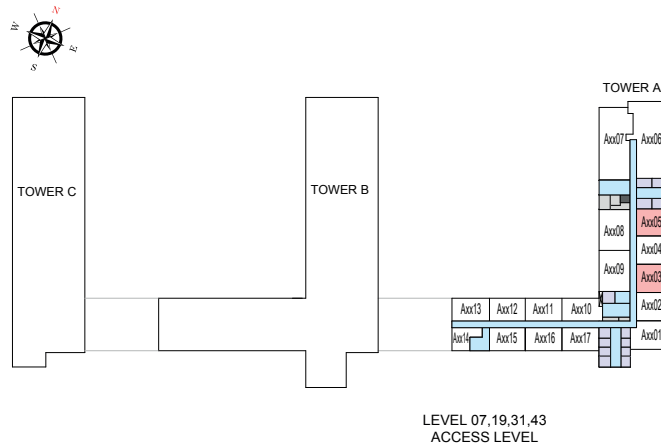

List of unit numbers with this unit plan:

## VIEWS

### Creek

A703, A705, A1303, A1305, A1903, A1905, A3103, A3105, A3703, A3705, A4303, A4305, A5503, A5505

Disclaimer: 1. All dimensions are in metric, measured to wall finishes. 2. All materials, dimensions & drawings are approximate. 3. Information is subject to change without notice, at developer's absolute discretion. 4. Actual area may vary from the stated area. 5. Drawing are not to scale. 6. All images used are for illustrative purpose only and do not represent the actual size, features, specifications, fittings and furnishings. 7. The developer reserves the right to make revisions/ alterations, at its absolute discretion, without any liability whatsoever.

# 2 BEDROOM APARTMENT

## TYPE A (with powder room + balcony)

### TOTAL SALEABLE AREA

SUITE = 1,034.63 SQ.FT.  
 BALCONY = 64.69 SQ.FT.  
 TOTAL = 1,099.32 SQ.FT.

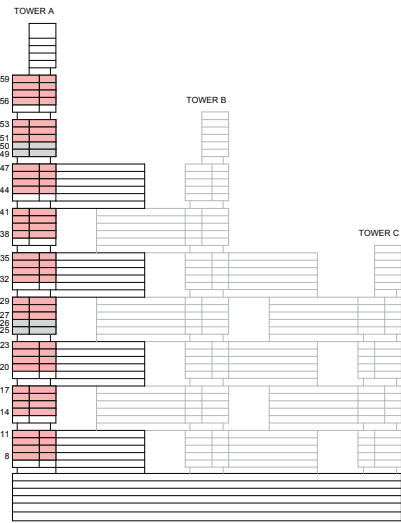

KEY ELEVATION

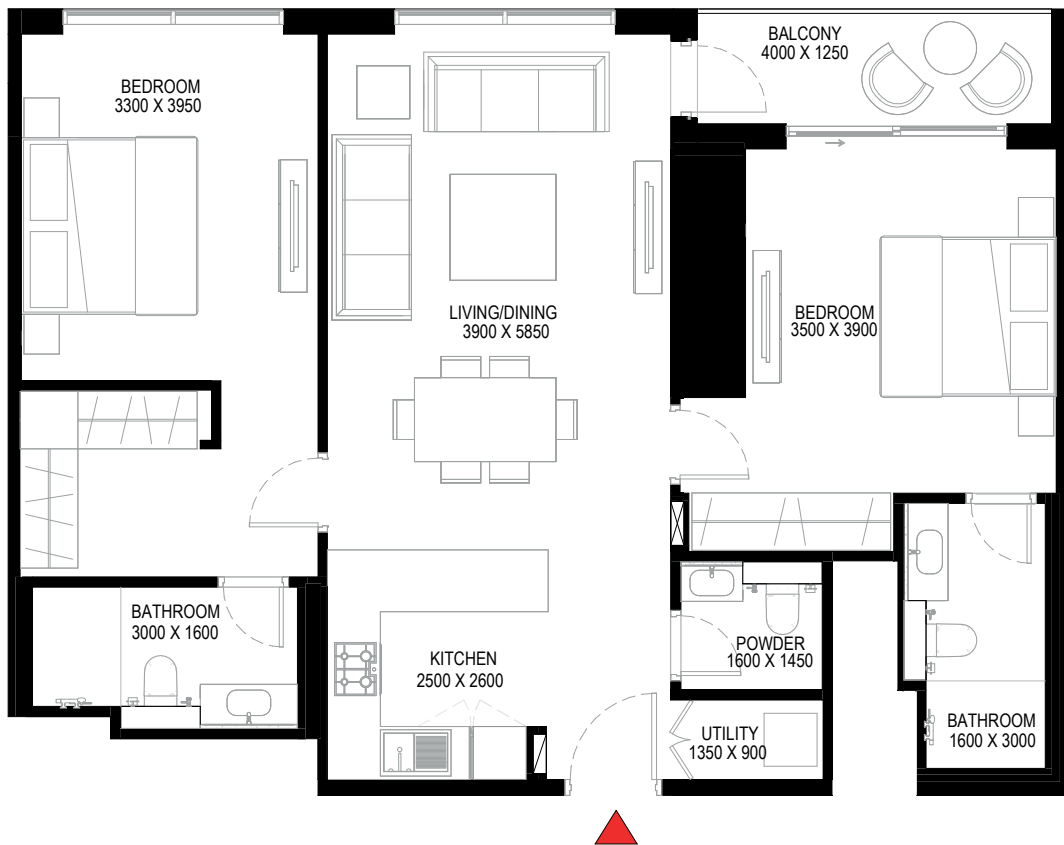
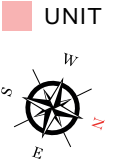

List of unit numbers with this unit plan:

### VIEWS

Ras Al Khor, Amenities  
 A809, A909

Ras Al Khor, Golf Course, Amenities  
 A1009, A1109, A1409, A1509, A1609, A1709, A2009, A2109, A2209, A2309

Ras Al Khor, Golf Course  
 A2709, A2809, A2909, A3209, A3309, A3409, A3509, A3809, A3909, A4009, A4109, A4409, A4509, A4609, A4709, A5110, A5210, A5310, A5610, A5710, A5810, A5910

Disclaimer: 1. All dimensions are in metric, measured to wall finishes. 2. All materials, dimensions & drawings are approximate. 3. Information is subject to change without notice, at developer's absolute discretion. 4. Actual area may vary from the stated area. 5. Drawing are not to scale. 6. All images used are for illustrative purpose only and do not represent the actual size, features, specifications, fittings and furnishings. 7. The developer reserves the right to make revisions/ alterations, at its absolute discretion, without any liability whatsoever.

# 2 BEDROOM APARTMENT

## TYPE A (with powder room + balcony)

**TOTAL SALEABLE AREA**

SUITE = 1,034.63 SQ.FT.

BALCONY = 64.69 SQ.FT.

TOTAL = 1,099.32 SQ.FT.

 UNIT

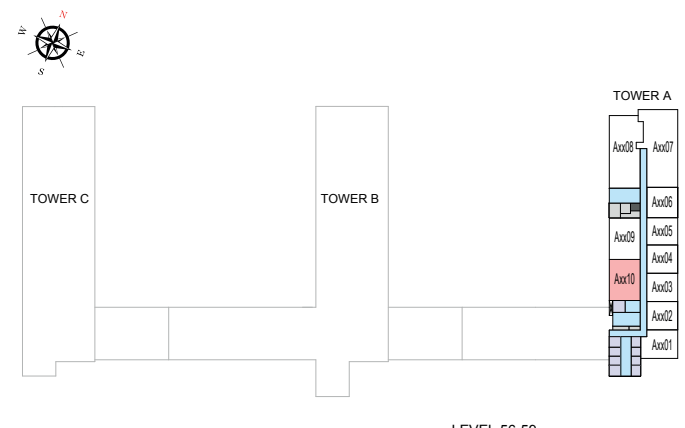
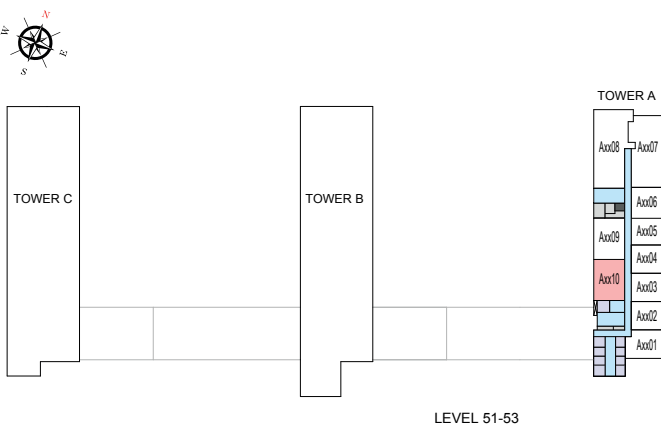
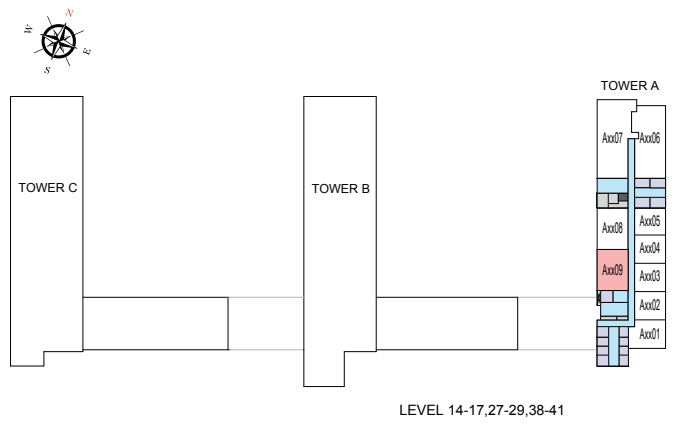
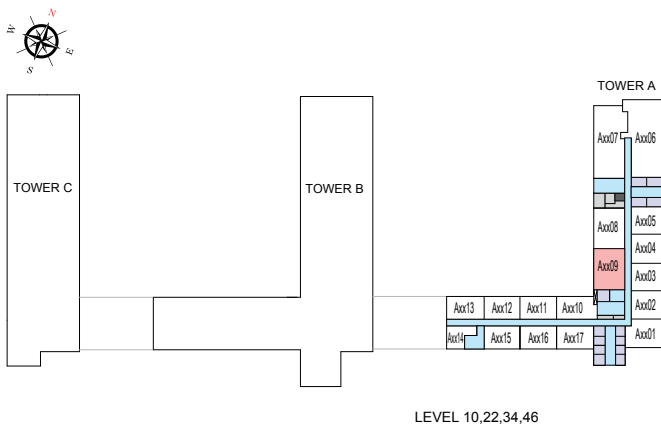
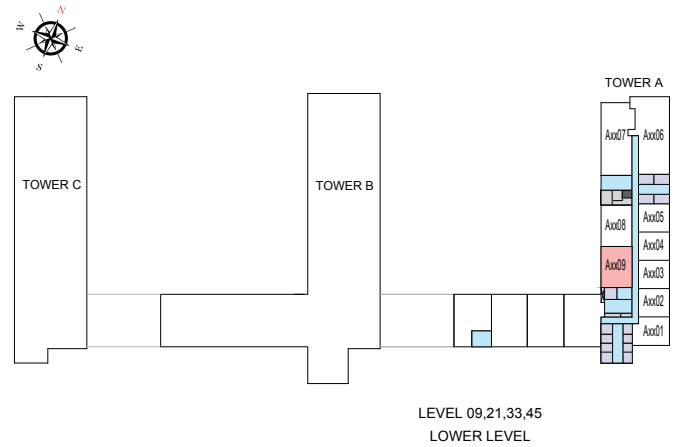
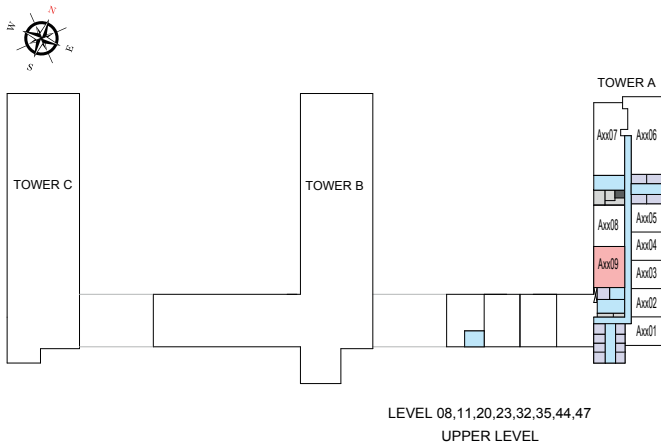

List of unit numbers with this unit plan:

### VIEWS

**Ras Al Khor, Amenities**  
A809, A909

**Ras Al Khor, Golf Course, Amenities**  
A1009, A1109, A1409, A1509, A1609, A1709, A2009, A2109, A2209, A2309

**Ras Al Khor, Golf Course**  
A2709, A2809, A2909, A3209, A3309, A3409, A3509, A3809, A3909, A4009, A4109, A4409, A4509, A4609, A4709, A5110, A5210, A5310, A5610, A5710, A5810, A5910

Disclaimer: 1. All dimensions are in metric, measured to wall finishes. 2. All materials, dimensions & drawings are approximate. 3. Information is subject to change without notice, at developer's absolute discretion. 4. Actual area may vary from the stated area. 5. Drawing are not to scale. 6. All images used are for illustrative purpose only and do not represent the actual size, features, specifications, fittings and furnishings. 7. The developer reserves the right to make revisions/ alterations, at its absolute discretion, without any liability whatsoever.

# 2 BEDROOM APARTMENT

TYPE A (with powder room + balcony) VARIANT 1

## TOTAL SALEABLE AREA

SUITE = 1,034.63 SQ.FT.

BALCONY = 64.69 SQ.FT.

TOTAL = 1,099.32 SQ.FT.

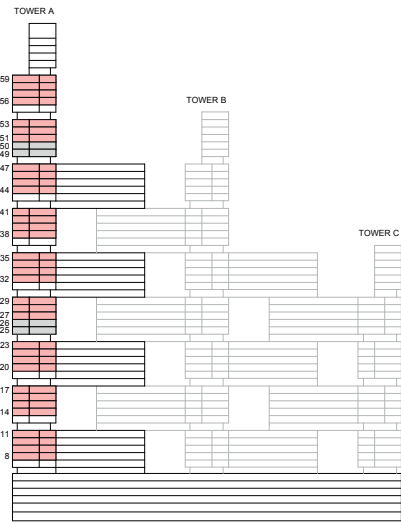

KEY ELEVATION

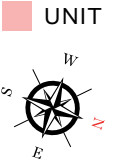

List of unit numbers with this unit plan:

## VIEWS

Ras Al Khor, Amenities  
A808, A908

Ras Al Khor, Golf Course, Amenities  
A1008, A1108, A1408, A1508, A1608, A1708, A2008, A2108, A2208, A2308

Ras Al Khor, Golf Course  
A2708, A2808, A2908, A3208, A3308, A3408, A3508, A3808, A3908, A4008, A4108, A4408, A4508, A4608, A4708, A5109, A5209, A5309, A5609, A5709, A5809, A5909

Disclaimer: 1. All dimensions are in metric, measured to wall finishes. 2. All materials, dimensions & drawings are approximate. 3. Information is subject to change without notice, at developer's absolute discretion. 4. Actual area may vary from the stated area. 5. Drawing are not to scale. 6. All images used are for illustrative purpose only and do not represent the actual size, features, specifications, fittings and furnishings. 7. The developer reserves the right to make revisions/ alterations, at its absolute discretion, without any liability whatsoever.

# 2 BEDROOM APARTMENT

TYPE A (with powder room + balcony) VARIANT 1

**TOTAL SALEABLE AREA**

SUITE = 1,034.63 SQ.FT.

BALCONY = 64.69 SQ.FT.

TOTAL = 1,099.32 SQ.FT.

 UNIT

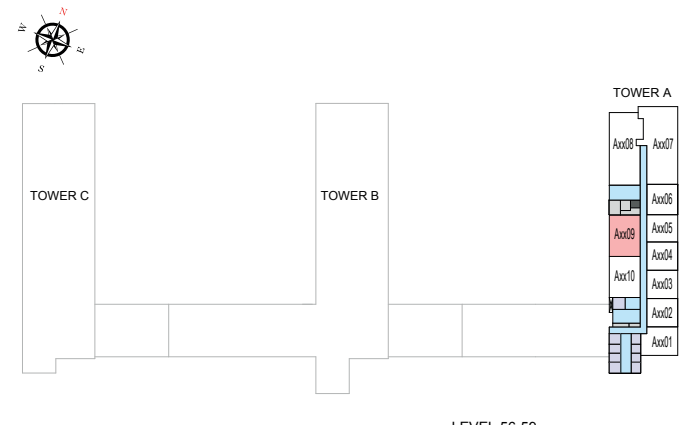
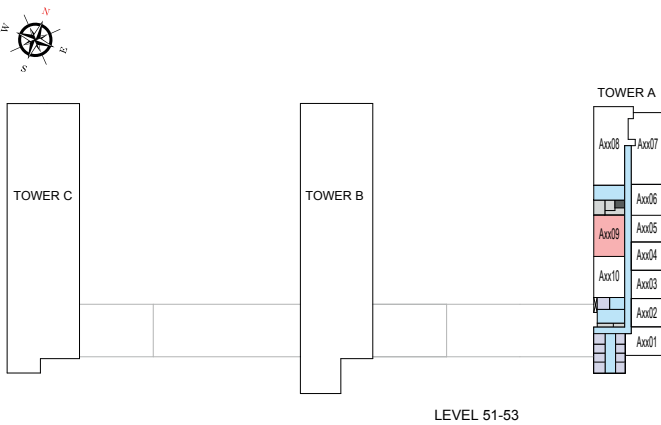
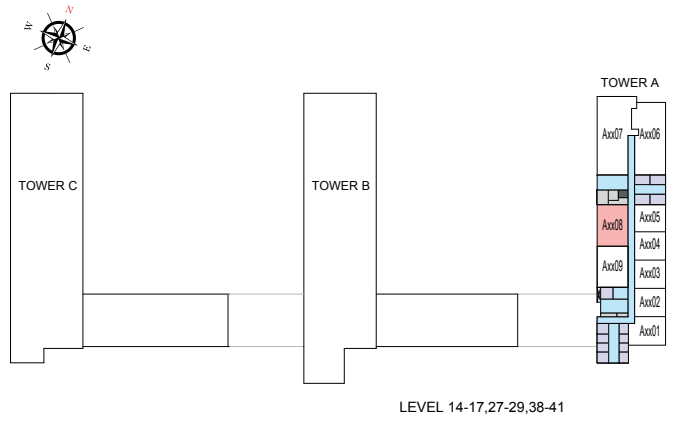
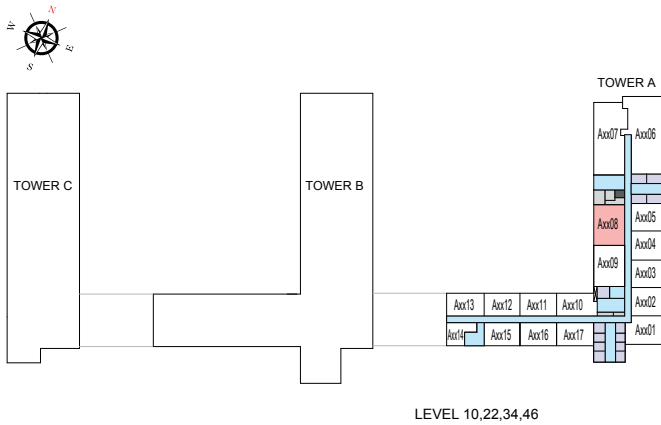
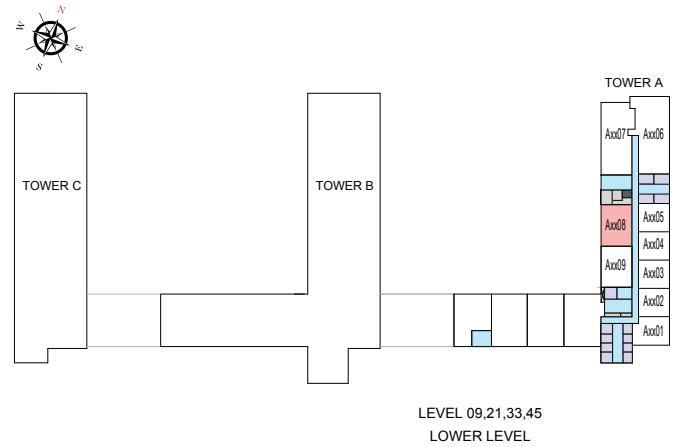
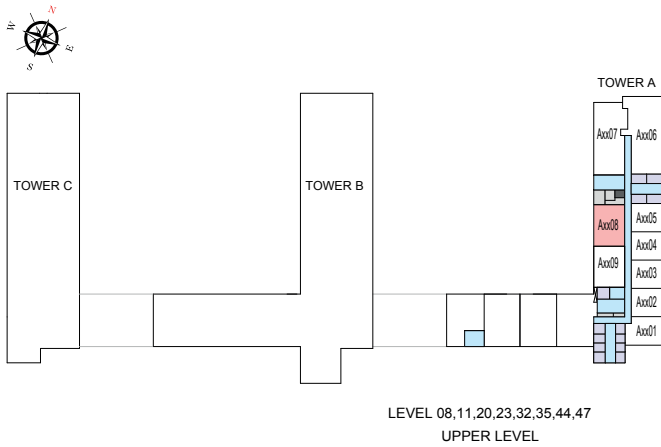

List of unit numbers with this unit plan:

## VIEWS

**Ras Al Khor, Amenities**  
A808, A908

**Ras Al Khor, Golf Course, Amenities**  
A1008, A1108, A1408, A1508, A1608, A1708, A2008, A2108, A2208, A2308

**Ras Al Khor, Golf Course**  
A2708, A2808, A2908, A3208, A3308, A3408, A3508, A3808, A3908, A4008, A4108, A4408, A4508, A4608, A4708, A5109, A5209, A5309, A5609, A5709, A5809, A5909

Disclaimer: 1. All dimensions are in metric, measured to wall finishes. 2. All materials, dimensions & drawings are approximate. 3. Information is subject to change without notice, at developer's absolute discretion. 4. Actual area may vary from the stated area. 5. Drawing are not to scale. 6. All images used are for illustrative purpose only and do not represent the actual size, features, specifications, fittings and furnishings. 7. The developer reserves the right to make revisions/ alterations, at its absolute discretion, without any liability whatsoever.

# 2 BEDROOM APARTMENT

TYPE G (with powder room + yard)

## TOTAL SALEABLE AREA

SUITE = 1,025.05 SQ.FT.

YARD = 184.82 SQ.FT.

TOTAL = 1,209.87 SQ.FT.

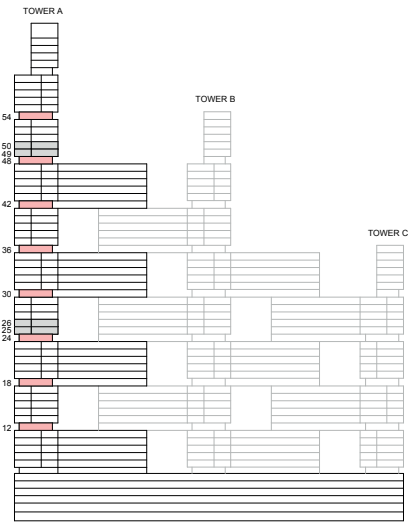

KEY ELEVATION

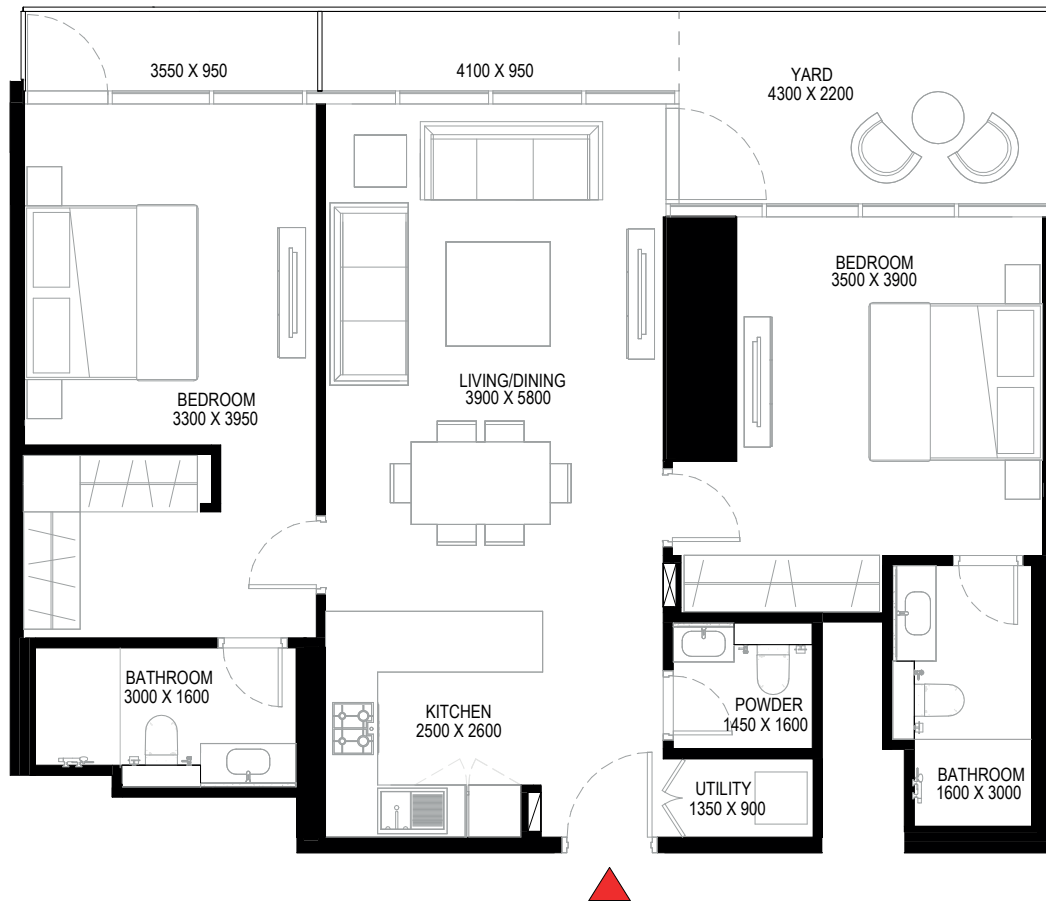

List of unit numbers with this unit plan:

## VIEWS

Ras Al Khor, Golf Course, Amenities  
A1209, A1809, A2409

Ras Al Khor, Golf Course  
A3009, A3609, A4209, A4809, A5410

Disclaimer: 1. All dimensions are in metric, measured to wall finishes. 2. All materials, dimensions & drawings are approximate. 3. Information is subject to change without notice, at developer's absolute discretion. 4. Actual area may vary from the stated area. 5. Drawing are not to scale. 6. All images used are for illustrative purpose only and do not represent the actual size, features, specifications, fittings and furnishings. 7. The developer reserves the right to make revisions/ alterations, at its absolute discretion, without any liability whatsoever.

# 2 BEDROOM APARTMENT

TYPE G (with powder room + yard)

## TOTAL SALEABLE AREA

SUITE = 1,025.05 SQ.FT.

YARD = 184.82 SQ.FT.

TOTAL = 1,209.87 SQ.FT.

■ UNIT

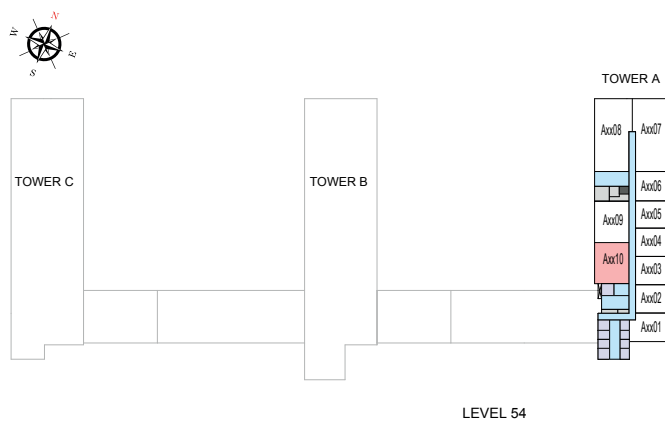
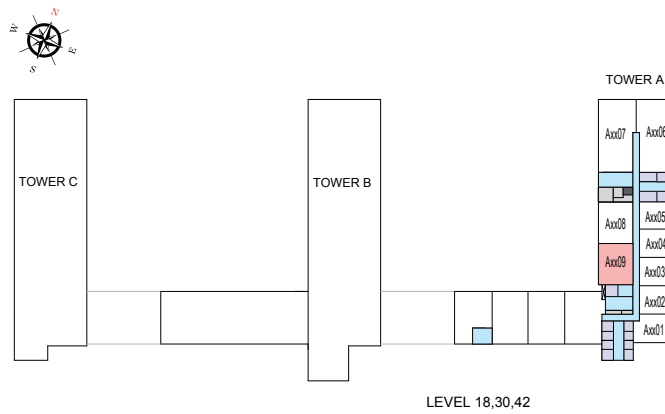
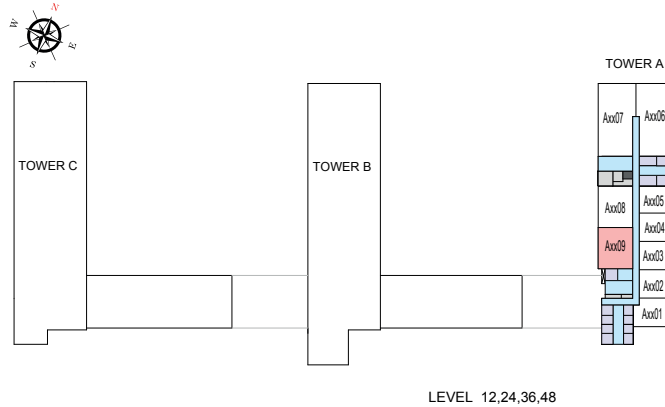

List of unit numbers with this unit plan:

## VIEWS

Ras Al Khor, Golf Course, Amenities

A1209, A1809, A2409

Ras Al Khor, Golf Course

A3009, A3609, A4209, A4809, A5410

Disclaimer: 1. All dimensions are in metric, measured to wall finishes. 2. All materials, dimensions & drawings are approximate. 3. Information is subject to change without notice, at developer's absolute discretion. 4. Actual area may vary from the stated area. 5. Drawing are not to scale. 6. All images used are for illustrative purpose only and do not represent the actual size, features, specifications, fittings and furnishings. 7. The developer reserves the right to make revisions/ alterations, at its absolute discretion, without any liability whatsoever.



# 2 BEDROOM APARTMENT

TYPE G (with powder room + yard) VARIANT 1

## TOTAL SALEABLE AREA

SUITE = 1,025.05 SQ.FT.

YARD = 184.82 SQ.FT.

TOTAL = 1,209.87 SQ.FT.

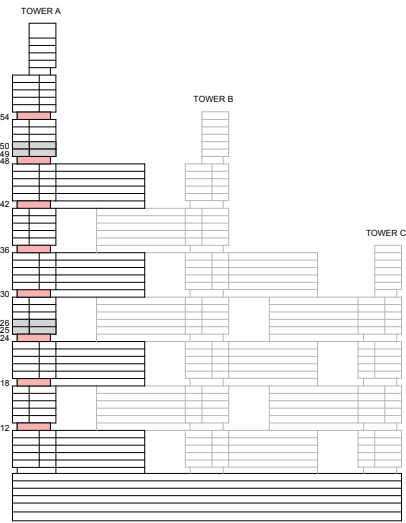

KEY ELEVATION

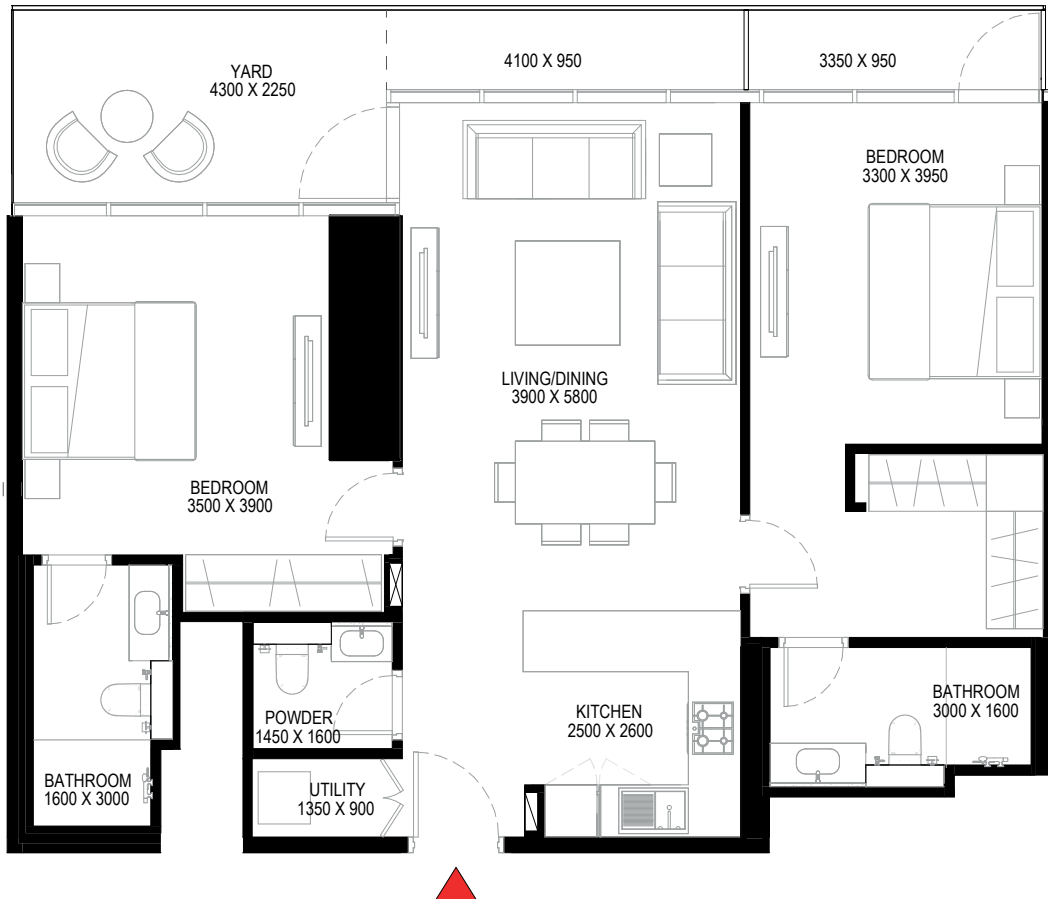

List of unit numbers with this unit plan:

## VIEWS

Ras Al Khor, Golf Course, Amenities  
A1208, A1808, A2408

Ras Al Khor, Golf Course  
A3008, A3608, A4208, A4808, A5409

Disclaimer: 1. All dimensions are in metric, measured to wall finishes. 2. All materials, dimensions & drawings are approximate. 3. Information is subject to change without notice, at developer's absolute discretion. 4. Actual area may vary from the stated area. 5. Drawing are not to scale. 6. All images used are for illustrative purpose only and do not represent the actual size, features, specifications, fittings and furnishings. 7. The developer reserves the right to make revisions/ alterations, at its absolute discretion, without any liability whatsoever.

# 2 BEDROOM APARTMENT

TYPE G (with powder room + yard) VARIANT 1

## TOTAL SALEABLE AREA

SUITE = 1,025.05 SQ.FT.

YARD = 184.82 SQ.FT.

TOTAL = 1,209.87 SQ.FT.

■ UNIT

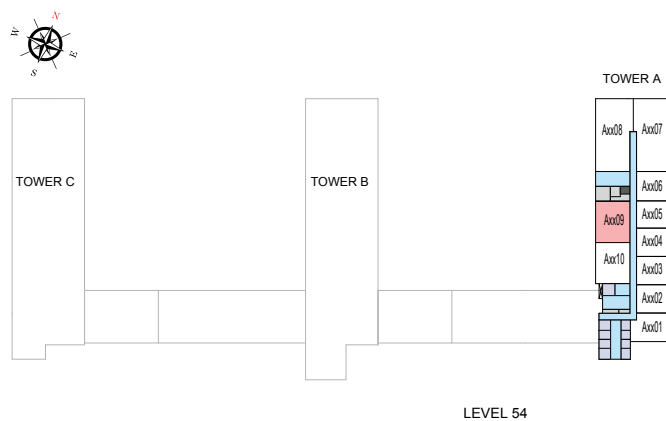
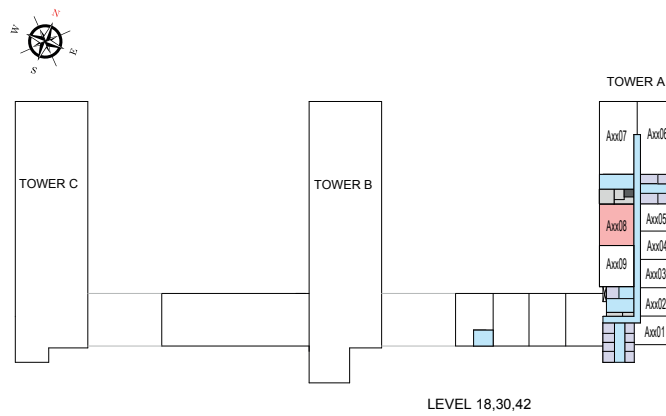
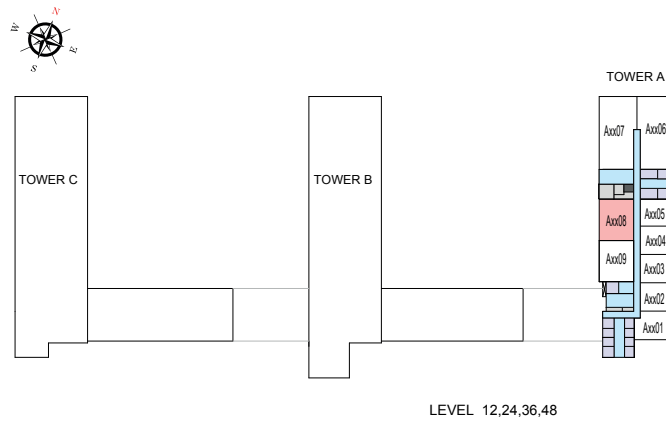

List of unit numbers with this unit plan:

## VIEWS

Ras Al Khor, Golf Course, Amenities

A1208, A1808, A2408

Ras Al Khor, Golf Course

A3008, A3608, A4208, A4808, A5409

Disclaimer: 1. All dimensions are in metric, measured to wall finishes. 2. All materials, dimensions & drawings are approximate. 3. Information is subject to change without notice, at developer's absolute discretion. 4. Actual area may vary from the stated area. 5. Drawing are not to scale. 6. All images used are for illustrative purpose only and do not represent the actual size, features, specifications, fittings and furnishings. 7. The developer reserves the right to make revisions/ alterations, at its absolute discretion, without any liability whatsoever.

# 2 BEDROOM APARTMENT

TYPE P (with powder room + yard)

## TOTAL SALEABLE AREA

SUITE = 1,034.61 SQ.FT.

YARD = 178.41 SQ.FT.

TOTAL = 1,213.02 SQ.FT.

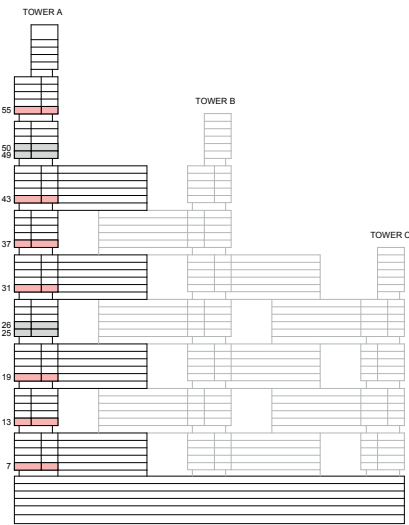

KEY ELEVATION

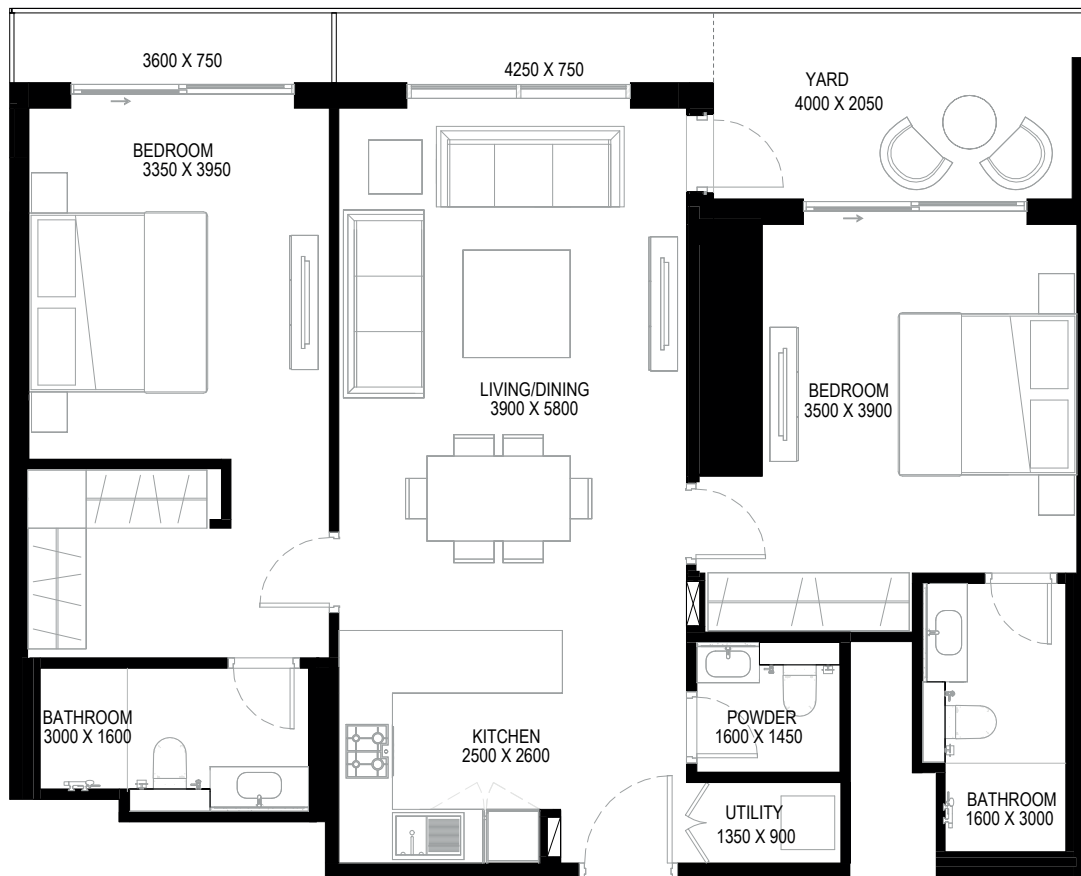

List of unit numbers with this unit plan:

## VIEWS

Ras Al Khor, Amenities  
A709

Ras Al Khor, Golf Course, Amenities  
A1309, A1909

Ras Al Khor, Golf Course  
A3109, A3709, A4309, A5510

Disclaimer: 1. All dimensions are in metric, measured to wall finishes. 2. All materials, dimensions & drawings are approximate. 3. Information is subject to change without notice, at developer's absolute discretion. 4. Actual area may vary from the stated area. 5. Drawing are not to scale. 6. All images used are for illustrative purpose only and do not represent the actual size, features, specifications, fittings and furnishings. 7. The developer reserves the right to make revisions/ alterations, at its absolute discretion, without any liability whatsoever.

# 2 BEDROOM APARTMENT

TYPE P (with powder room + yard)

**TOTAL SALEABLE AREA**

SUITE = 1,034.61 SQ.FT.

YARD = 178.41 SQ.FT.

TOTAL = 1,213.02 SQ.FT.

 UNIT

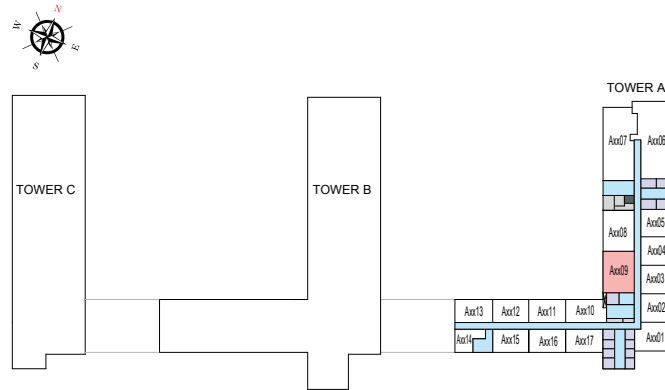

LEVEL 07, 19, 31, 43  
ACCESS LEVEL

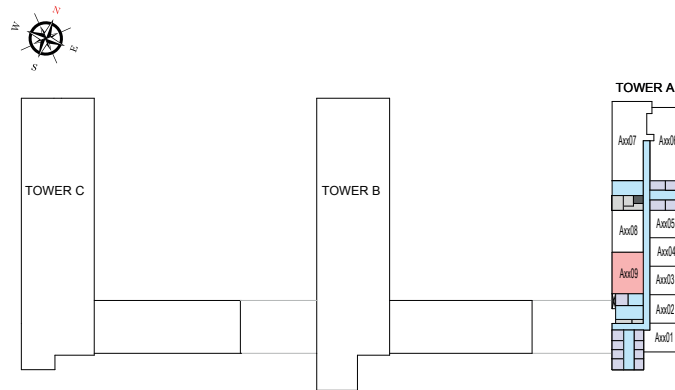

LEVEL 13, 37

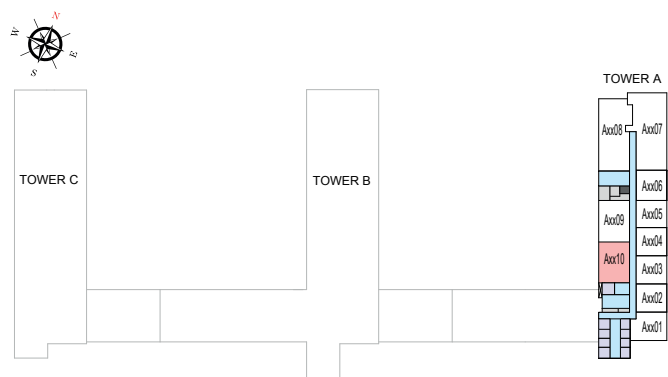

LEVEL 55

List of unit numbers with this unit plan:

## VIEWS

Ras Al Khor, Amenities  
A709

Ras Al Khor, Golf Course, Amenities  
A1309, A1909

Ras Al Khor, Golf Course  
A3109, A3709, A4309, A5510

Disclaimer: 1. All dimensions are in metric, measured to wall finishes. 2. All materials, dimensions & drawings are approximate. 3. Information is subject to change without notice, at developer's absolute discretion. 4. Actual area may vary from the stated area. 5. Drawing are not to scale. 6. All images used are for illustrative purpose only and do not represent the actual size, features, specifications, fittings and furnishings. 7. The developer reserves the right to make revisions/ alterations, at its absolute discretion, without any liability whatsoever.

# 2 BEDROOM APARTMENT

TYPE P (with powder room + yard) VARIANT 1

## TOTAL SALEABLE AREA

SUITE = 1,034.61 SQ.FT.

YARD = 178.41 SQ.FT.

TOTAL = 1,213.02 SQ.FT.

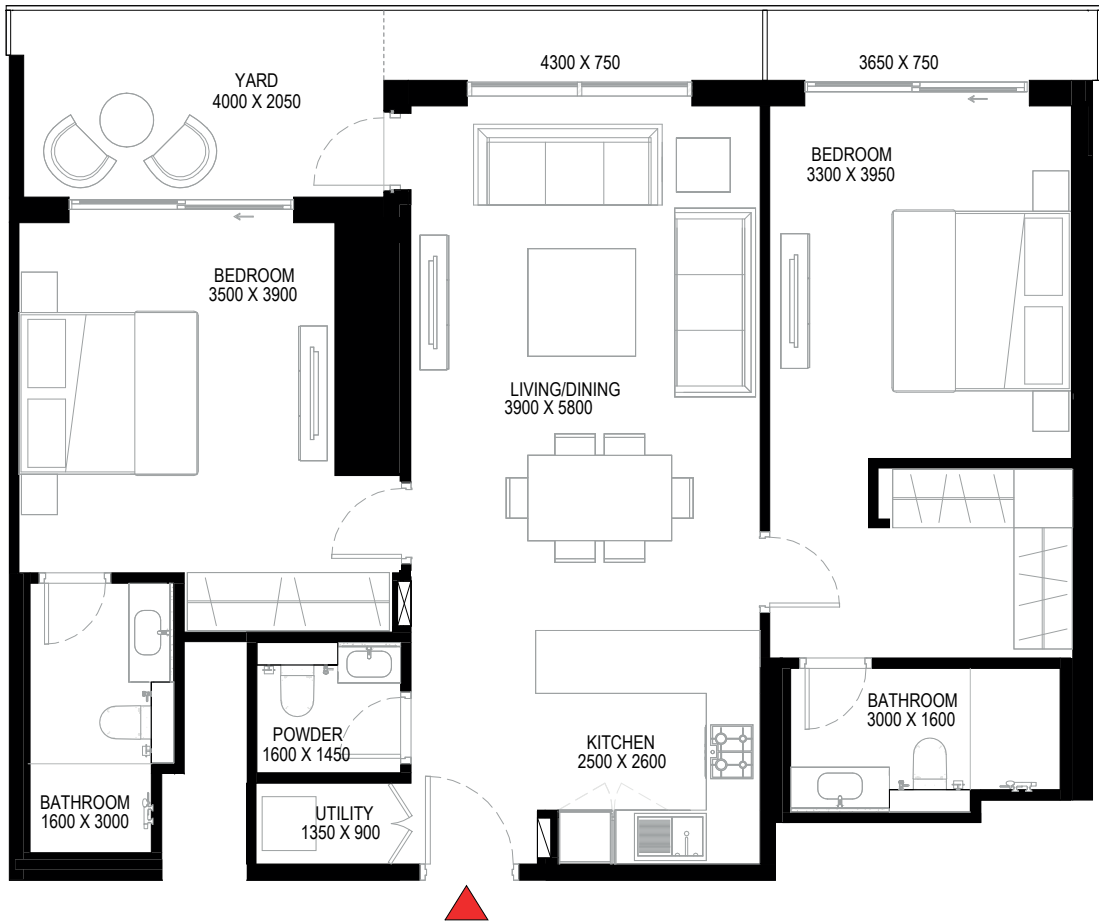
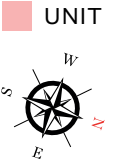
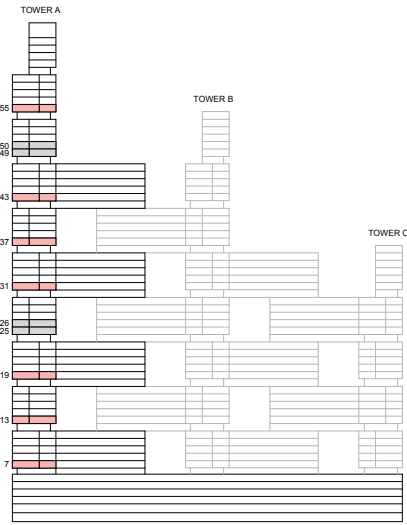

List of unit numbers with this unit plan:

## VIEWS

Ras Al Khor, Golf Course, Amenities  
A708, A1308, A1908

Ras Al Khor, Golf Course  
A3108, A3708, A4308, A5509

Disclaimer: 1. All dimensions are in metric, measured to wall finishes. 2. All materials, dimensions & drawings are approximate. 3. Information is subject to change without notice, at developer's absolute discretion. 4. Actual area may vary from the stated area. 5. Drawing are not to scale. 6. All images used are for illustrative purpose only and do not represent the actual size, features, specifications, fittings and furnishings. 7. The developer reserves the right to make revisions/ alterations, at its absolute discretion, without any liability whatsoever.

# 2 BEDROOM APARTMENT

TYPE P (with powder room + yard) VARIANT 1

**TOTAL SALEABLE AREA**

SUITE = 1,034.61 SQ.FT.

YARD = 178.41 SQ.FT.

TOTAL = 1,213.02 SQ.FT.

■ UNIT

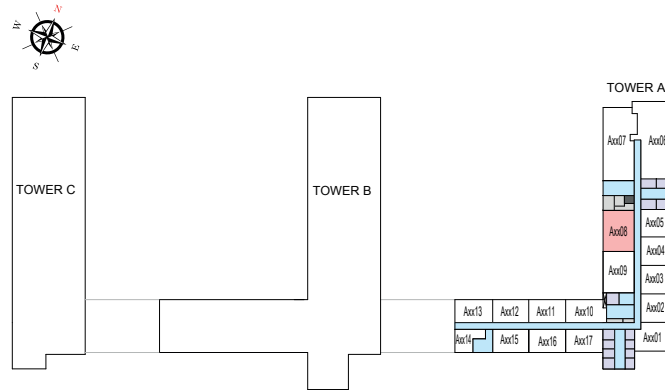

LEVEL 07,19,31,43  
ACCESS LEVEL

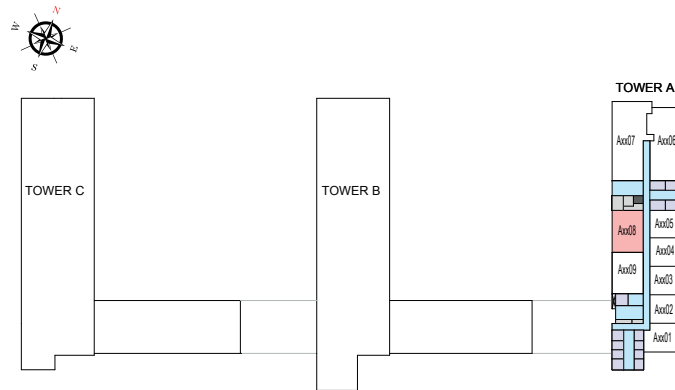

LEVEL 13,37

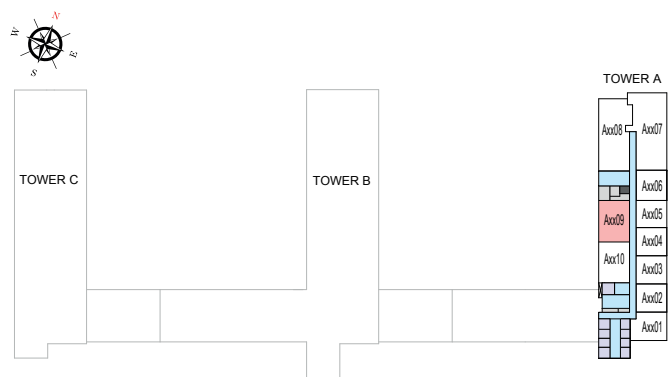

LEVEL 55

List of unit numbers with this unit plan:

## VIEWS

Ras Al Khor, Golf Course, Amenities  
A708, A1308, A1908

Ras Al Khor, Golf Course  
A3108, A3708, A4308, A5509

Disclaimer: 1. All dimensions are in metric, measured to wall finishes. 2. All materials, dimensions & drawings are approximate. 3. Information is subject to change without notice, at developer's absolute discretion. 4. Actual area may vary from the stated area. 5. Drawing are not to scale. 6. All images used are for illustrative purpose only and do not represent the actual size, features, specifications, fittings and furnishings. 7. The developer reserves the right to make revisions/ alterations, at its absolute discretion, without any liability whatsoever.

# 3 BEDROOM APARTMENT

TYPE A (with maid room + balcony)

**TOTAL SALEABLE AREA**

SUITE = 1,642.57 SQ.FT.

BALCONY = 274.54 SQ.FT.

TOTAL = 1,917.11 SQ.FT.

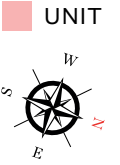
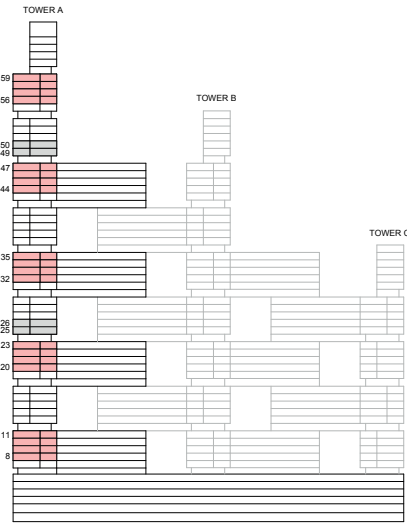

List of unit numbers with this unit plan:

## VIEWS

Downtown, Ras Al Khor, Creek, Golf Course, Water Body, Amenities

A807, A907, A1007, A1107, A2007, A2107, A2207, A2307

Downtown, Ras Al Khor, Creek, Golf Course, Water Body

A3207, A3307, A3407, A3507, A4407, A4507, A4607, A4707, A5608, A5708, A5808, A5908

Disclaimer: 1. All dimensions are in metric, measured to wall finishes. 2. All materials, dimensions & drawings are approximate. 3. Information is subject to change without notice, at developer's absolute discretion. 4. Actual area may vary from the stated area. 5. Drawing are not to scale. 6. All images used are for illustrative purpose only and do not represent the actual size, features, specifications, fittings and furnishings. 7. The developer reserves the right to make revisions/ alterations, at its absolute discretion, without any liability whatsoever.

# 3 BEDROOM APARTMENT

TYPE A (with maid room + balcony)

**TOTAL SALEABLE AREA**

SUITE = 1,642.57 SQ.FT.

BALCONY = 274.54 SQ.FT.

TOTAL = 1,917.11 SQ.FT.

■ UNIT

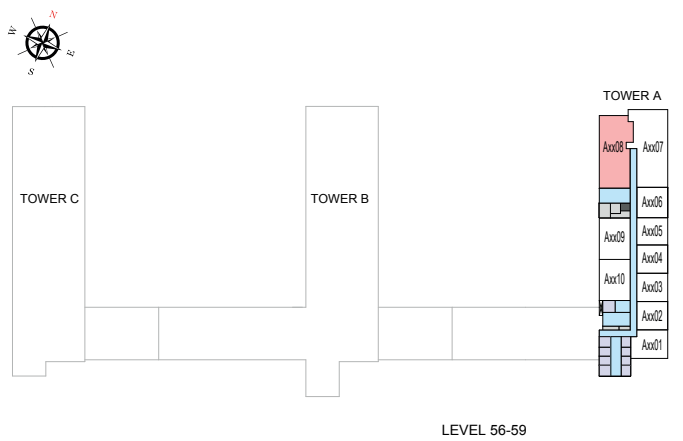
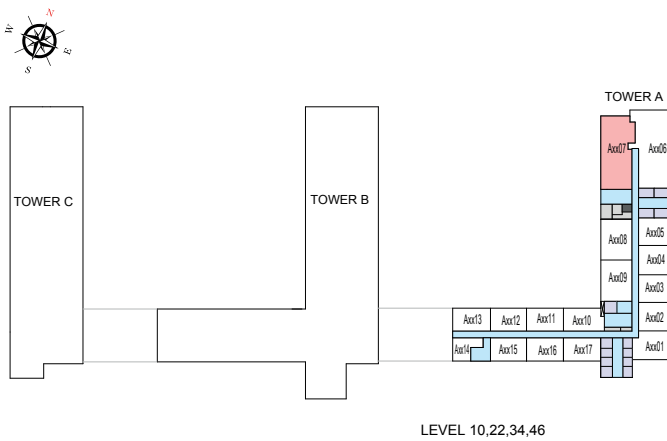
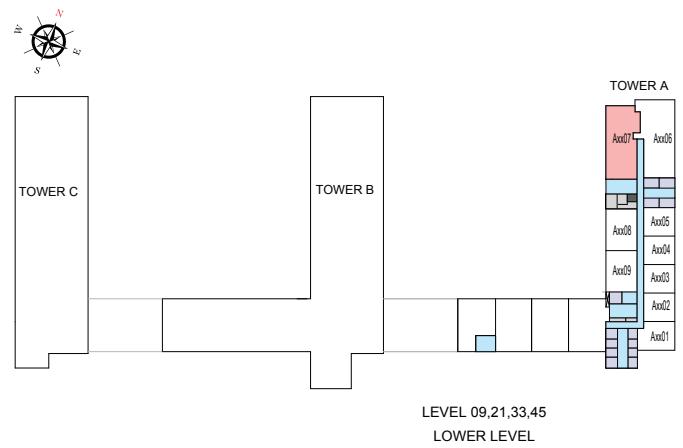
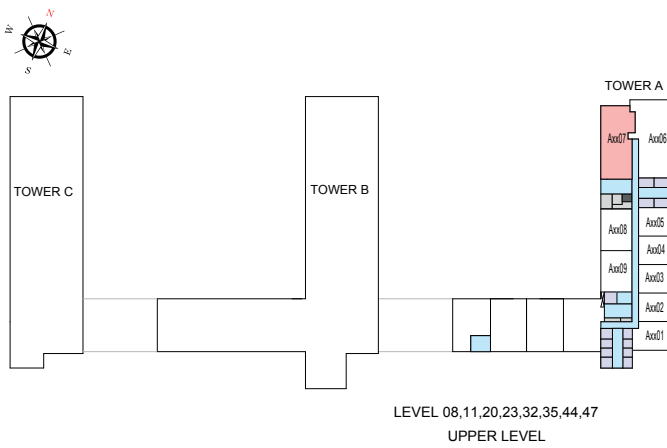

List of unit numbers with this unit plan:

## VIEWS

**Downtown, Ras Al Khor, Creek, Golf Course, Water Body, Amenities**

A807, A907, A1007, A1107, A2007, A2107, A2207, A2307

**Downtown, Ras Al Khor, Creek, Golf Course, Water Body**

A3207, A3307, A3407, A3507, A4407, A4507, A4607, A4707, A5608, A5708, A5808, A5908

Disclaimer: 1. All dimensions are in metric, measured to wall finishes. 2. All materials, dimensions & drawings are approximate. 3. Information is subject to change without notice, at developer's absolute discretion. 4. Actual area may vary from the stated area. 5. Drawing are not to scale. 6. All images used are for illustrative purpose only and do not represent the actual size, features, specifications, fittings and furnishings. 7. The developer reserves the right to make revisions/ alterations, at its absolute discretion, without any liability whatsoever.



# 3 BEDROOM APARTMENT

TYPE A (with maid room + balcony) VARIANT 1

**TOTAL SALEABLE AREA**

SUITE = 1,642.57 SQ.FT.

BALCONY = 274.54 SQ.FT.

TOTAL = 1,917.11 SQ.FT.

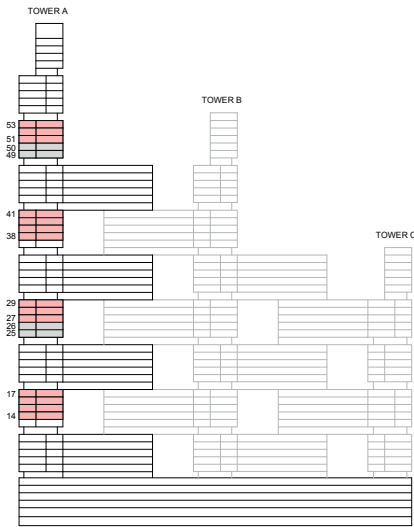

KEY ELEVATION

UNIT

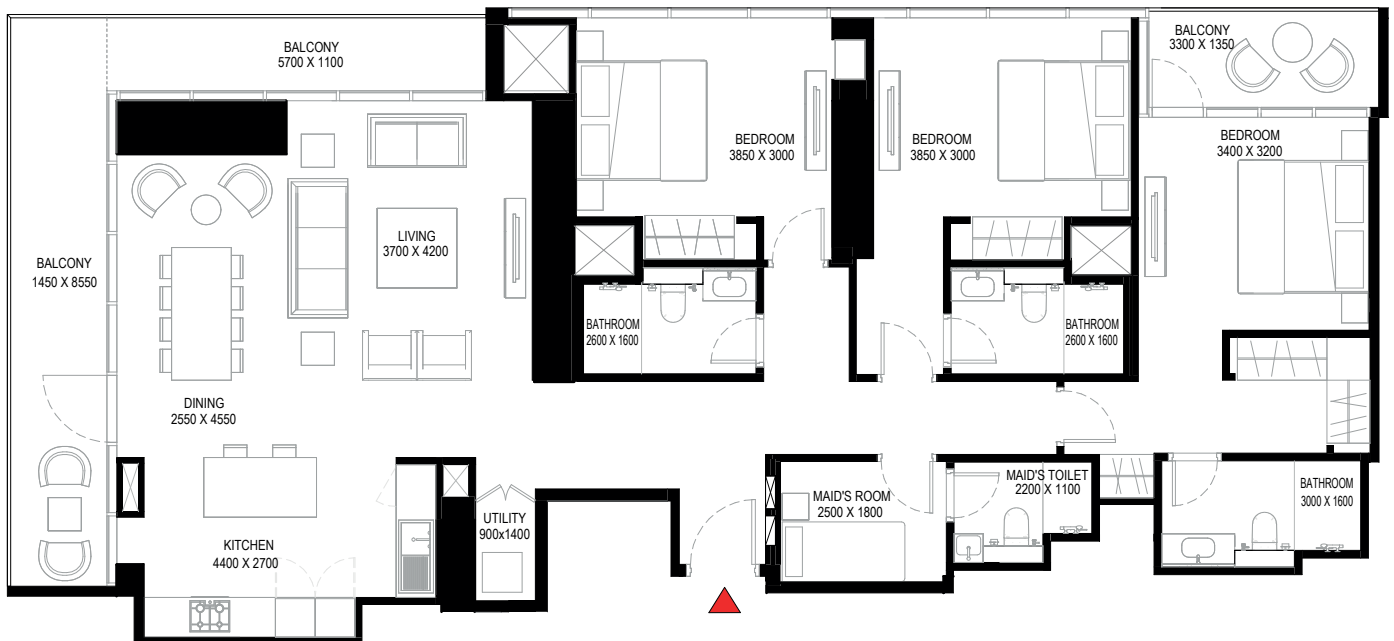
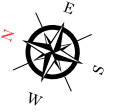

List of unit numbers with this unit plan:

## VIEWS

Ras Al Khor, Creek, Golf Course

A1406, A1506, A1606, A1706, A2706, A2806, A2906, A3806, A3906, A4006, A4106, A5107, A5207, A5307

Disclaimer: 1. All dimensions are in metric, measured to wall finishes. 2. All materials, dimensions & drawings are approximate. 3. Information is subject to change without notice, at developer's absolute discretion. 4. Actual area may vary from the stated area. 5. Drawing are not to scale. 6. All images used are for illustrative purpose only and do not represent the actual size, features, specifications, fittings and furnishings. 7. The developer reserves the right to make revisions/ alterations, at its absolute discretion, without any liability whatsoever.

# 3 BEDROOM APARTMENT

TYPE A (with maid room + balcony) VARIANT 1

**TOTAL SALEABLE AREA**

SUITE = 1,642.57 SQ.FT.

BALCONY = 274.54 SQ.FT.

TOTAL = 1,917.11 SQ.FT.

 UNIT

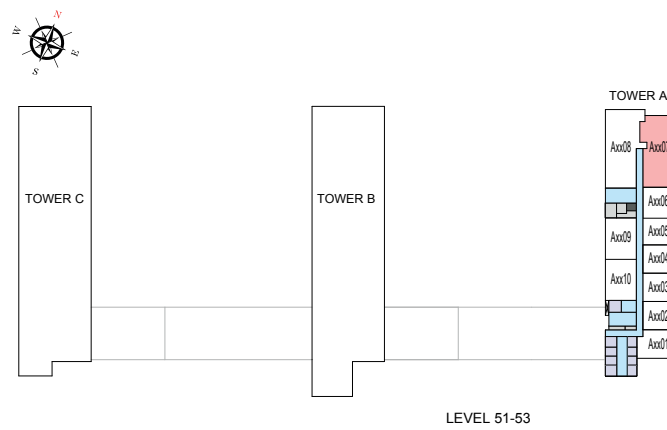
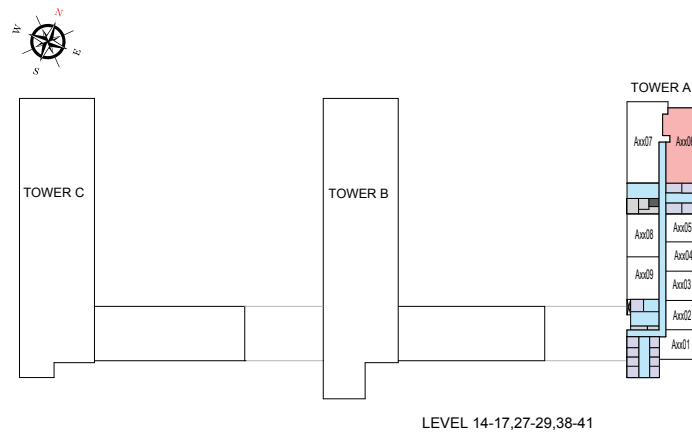

List of unit numbers with this unit plan:

## VIEWS

Ras Al Khor, Creek, Golf Course

A1406, A1506, A1606, A1706, A2706, A2806, A2906, A3806, A3906, A4006, A4106, A5107, A5207, A5307

Disclaimer: 1. All dimensions are in metric, measured to wall finishes. 2. All materials, dimensions & drawings are approximate. 3. Information is subject to change without notice, at developer's absolute discretion. 4. Actual area may vary from the stated area. 5. Drawing are not to scale. 6. All images used are for illustrative purpose only and do not represent the actual size, features, specifications, fittings and furnishings. 7. The developer reserves the right to make revisions/ alterations, at its absolute discretion, without any liability whatsoever.

# 3 BEDROOM APARTMENT

TYPE C (with store room and maid room + yard)

**TOTAL SALEABLE AREA**

SUITE = 1,708.66 SQ.FT.

YARD = 782.88 SQ.FT.

TOTAL = 2,491.54 SQ.FT.

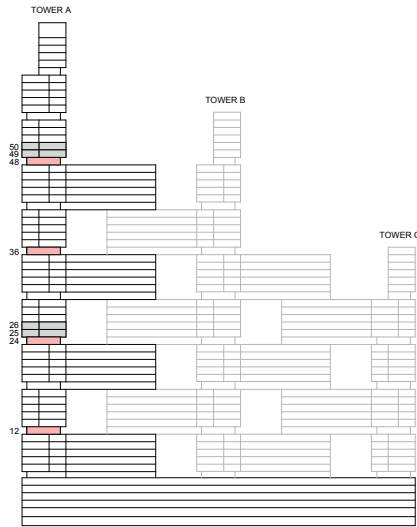

KEY ELEVATION

UNIT

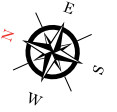

List of unit numbers with this unit plan:

## VIEWS

Downtown, Ras Al Khor, Creek, Golf Course, Water Body  
A1206, A2406, A3606, A4806

Disclaimer: 1. All dimensions are in metric, measured to wall finishes. 2. All materials, dimensions & drawings are approximate. 3. Information is subject to change without notice, at developer's absolute discretion. 4. Actual area may vary from the stated area. 5. Drawing are not to scale. 6. All images used are for illustrative purpose only and do not represent the actual size, features, specifications, fittings and furnishings. 7. The developer reserves the right to make revisions/ alterations, at its absolute discretion, without any liability whatsoever.

# 3 BEDROOM APARTMENT

TYPE C (with store room and maid room + yard)

## TOTAL SALEABLE AREA

SUITE = 1,708.66 SQ.FT.

YARD = 782.88 SQ.FT.

TOTAL = 2,491.54 SQ.FT.

 UNIT

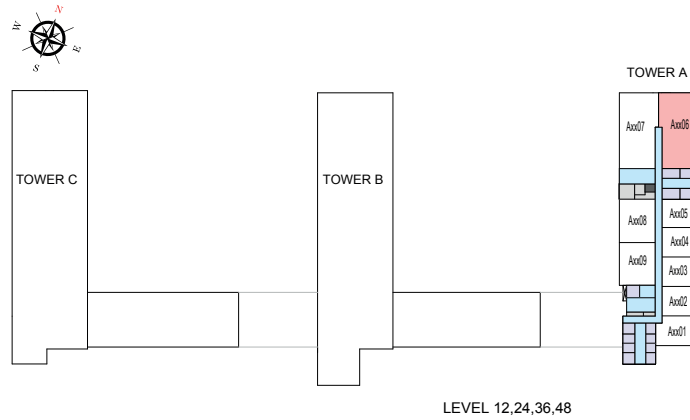

List of unit numbers with this unit plan:

## VIEWS

Downtown, Ras Al Khor, Creek, Golf Course, Water Body  
A1206, A2406, A3606, A4806

Disclaimer: 1. All dimensions are in metric, measured to wall finishes. 2. All materials, dimensions & drawings are approximate. 3. Information is subject to change without notice, at developer's absolute discretion. 4. Actual area may vary from the stated area. 5. Drawing are not to scale. 6. All images used are for illustrative purpose only and do not represent the actual size, features, specifications, fittings and furnishings. 7. The developer reserves the right to make revisions/ alterations, at its absolute discretion, without any liability whatsoever.

# 3 BEDROOM APARTMENT

TYPE C (with store room and maid room + yard) VARIANT 1

**TOTAL SALEABLE AREA**

SUITE = 1,708.66 SQ.FT.

YARD = 782.88 SQ.FT.

TOTAL = 2,491.54 SQ.FT.

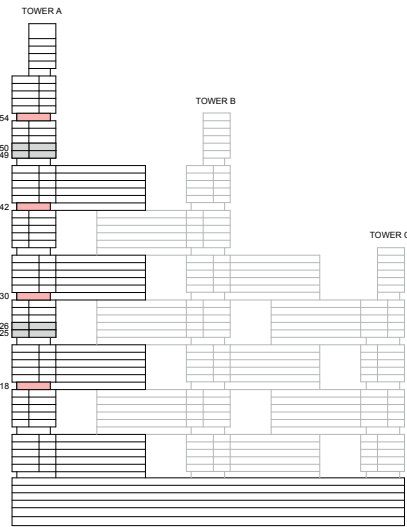

KEY ELEVATION



List of unit numbers with this unit plan:

## VIEWS

Downtown, Ras Al Khor, Creek, Golf Course, Water Body, Amenities  
A1807

Downtown, Ras Al Khor, Creek, Golf Course, Water Body  
A3007, A4207, A5408

Disclaimer: 1. All dimensions are in metric, measured to wall finishes. 2. All materials, dimensions & drawings are approximate. 3. Information is subject to change without notice, at developer's absolute discretion. 4. Actual area may vary from the stated area. 5. Drawing are not to scale. 6. All images used are for illustrative purpose only and do not represent the actual size, features, specifications, fittings and furnishings. 7. The developer reserves the right to make revisions/ alterations, at its absolute discretion, without any liability whatsoever.

# 3 BEDROOM APARTMENT

TYPE C (with store room and maid room + yard) VARIANT 1

## TOTAL SALEABLE AREA

SUITE = 1,708.66 SQ.FT.

YARD = 782.88 SQ.FT.

TOTAL = 2,491.54 SQ.FT.

■ UNIT

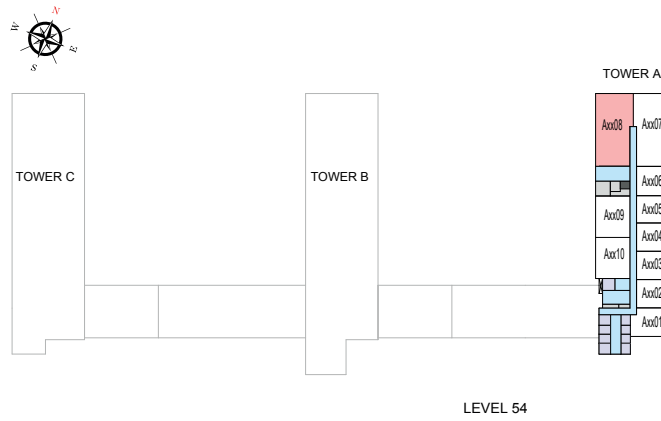
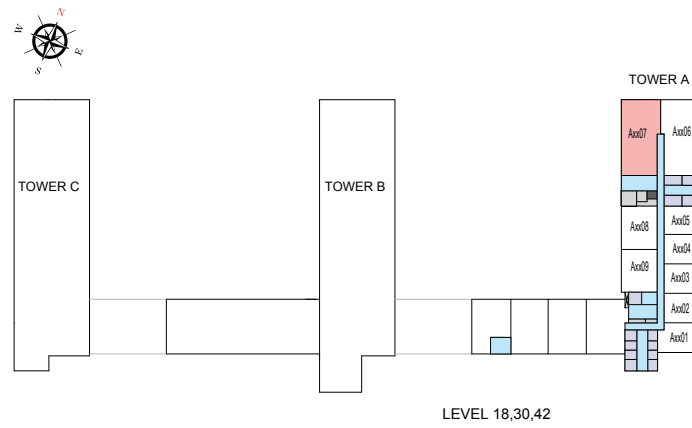

List of unit numbers with this unit plan:

## VIEWS

Downtown, Ras Al Khor, Creek, Golf Course, Water Body, Amenities  
A1807

Downtown, Ras Al Khor, Creek, Golf Course, Water Body  
A3007, A4207, A5408

Disclaimer: 1. All dimensions are in metric, measured to wall finishes. 2. All materials, dimensions & drawings are approximate. 3. Information is subject to change without notice, at developer's absolute discretion. 4. Actual area may vary from the stated area. 5. Drawing are not to scale. 6. All images used are for illustrative purpose only and do not represent the actual size, features, specifications, fittings and furnishings. 7. The developer reserves the right to make revisions/ alterations, at its absolute discretion, without any liability whatsoever.

# 3 BEDROOM APARTMENT

TYPE D (with store room and maid room + yard)

**TOTAL SALEABLE AREA**

SUITE = 1,708.66 SQ.FT.

YARD = 536.03 SQ.FT.

TOTAL = 2,244.69 SQ.FT.

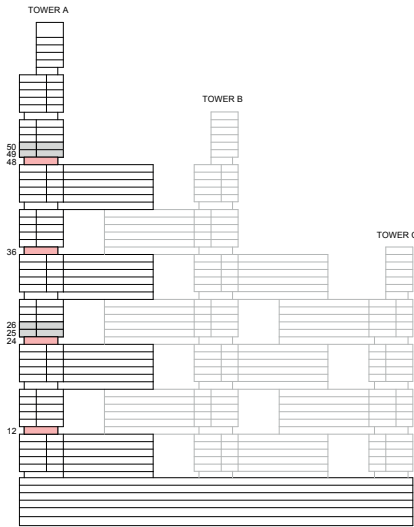

KEY ELEVATION

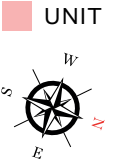

List of unit numbers with this unit plan:

## VIEWS

Downtown, Ras Al Khor, Creek, Golf Course, Water Body, Amenities  
A1207, A2407

Downtown, Ras Al Khor, Creek, Golf Course, Water Body  
A3607, A4807

Disclaimer: 1. All dimensions are in metric, measured to wall finishes. 2. All materials, dimensions & drawings are approximate. 3. Information is subject to change without notice, at developer's absolute discretion. 4. Actual area may vary from the stated area. 5. Drawing are not to scale. 6. All images used are for illustrative purpose only and do not represent the actual size, features, specifications, fittings and furnishings. 7. The developer reserves the right to make revisions/ alterations, at its absolute discretion, without any liability whatsoever.

# 3 BEDROOM APARTMENT

TYPE D (with store room and maid room + yard)

## TOTAL SALEABLE AREA

SUITE = 1,708.66 SQ.FT.

YARD = 536.03 SQ.FT.

TOTAL = 2,244.69 SQ.FT.

 UNIT

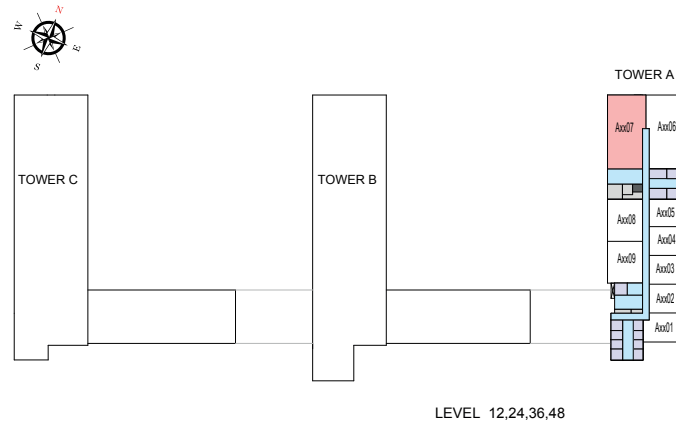

List of unit numbers with this unit plan:

## VIEWS

Downtown, Ras Al Khor, Creek, Golf Course, Water Body, Amenities  
A1207, A2407

Downtown, Ras Al Khor, Creek, Golf Course, Water Body  
A3607, A4807

Disclaimer: 1. All dimensions are in metric, measured to wall finishes. 2. All materials, dimensions & drawings are approximate. 3. Information is subject to change without notice, at developer's absolute discretion. 4. Actual area may vary from the stated area. 5. Drawing are not to scale. 6. All images used are for illustrative purpose only and do not represent the actual size, features, specifications, fittings and furnishings. 7. The developer reserves the right to make revisions/ alterations, at its absolute discretion, without any liability whatsoever.



# 3 BEDROOM APARTMENT

TYPE D (with store room and maid room + yard) VARIANT 1

## TOTAL SALEABLE AREA

SUITE = 1,708.66 SQ.FT.

YARD = 536.03 SQ.FT.

TOTAL = 2,244.69 SQ.FT.

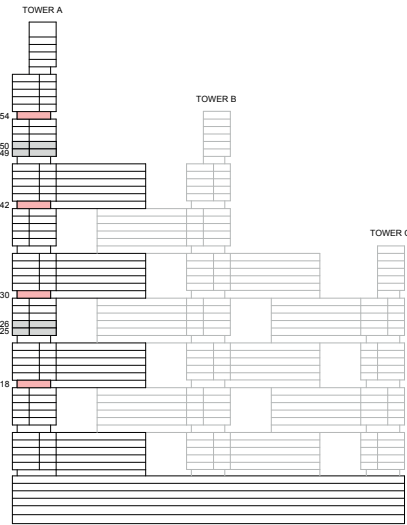

KEY ELEVATION

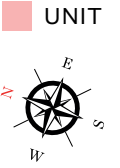

List of unit numbers with this unit plan:

## VIEWS

Downtown, Ras Al Khor, Creek, Golf Course, Water Body  
A1806, A3006, A4206, A5407

Disclaimer: 1. All dimensions are in metric, measured to wall finishes. 2. All materials, dimensions & drawings are approximate. 3. Information is subject to change without notice, at developer's absolute discretion. 4. Actual area may vary from the stated area. 5. Drawing are not to scale. 6. All images used are for illustrative purpose only and do not represent the actual size, features, specifications, fittings and furnishings. 7. The developer reserves the right to make revisions/ alterations, at its absolute discretion, without any liability whatsoever.

# 3 BEDROOM APARTMENT

TYPE D (with store room and maid room + yard) VARIANT 1

## TOTAL SALEABLE AREA

SUITE = 1,708.66 SQ.FT.

YARD = 536.03 SQ.FT.

TOTAL = 2,244.69 SQ.FT.

UNIT

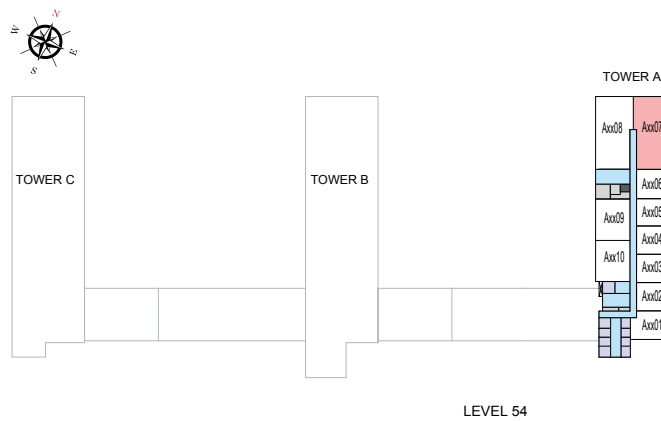
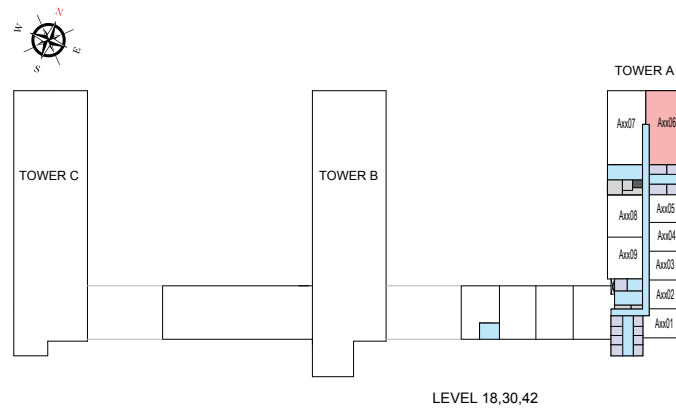

List of unit numbers with this unit plan:

## VIEWS

Downtown, Ras Al Khor, Creek, Golf Course, Water Body  
A1806, A3006, A4206, A5407

Disclaimer: 1. All dimensions are in metric, measured to wall finishes. 2. All materials, dimensions & drawings are approximate. 3. Information is subject to change without notice, at developer's absolute discretion. 4. Actual area may vary from the stated area. 5. Drawing are not to scale. 6. All images used are for illustrative purpose only and do not represent the actual size, features, specifications, fittings and furnishings. 7. The developer reserves the right to make revisions/ alterations, at its absolute discretion, without any liability whatsoever.

# 3 BEDROOM APARTMENT

TYPE E (with maid room + yard)

**TOTAL SALEABLE AREA**

SUITE = 1,642.57 SQ.FT.

YARD = 539.66 SQ.FT.

TOTAL = 2,182.23 SQ.FT.

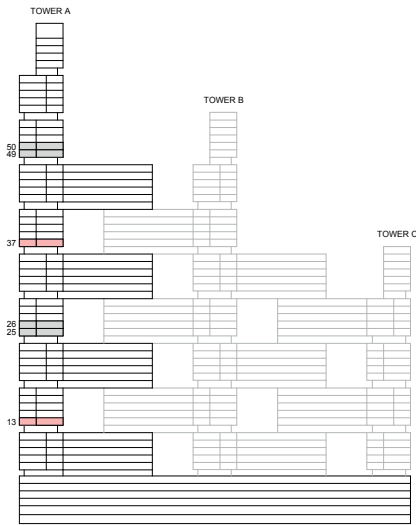

KEY ELEVATION

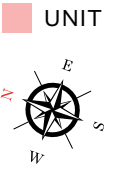

List of unit numbers with this unit plan:

## VIEWS

Ras Al Khor, Creek, Golf Course  
A1306, A3706

Disclaimer: 1. All dimensions are in metric, measured to wall finishes. 2. All materials, dimensions & drawings are approximate. 3. Information is subject to change without notice, at developer's absolute discretion. 4. Actual area may vary from the stated area. 5. Drawing are not to scale. 6. All images used are for illustrative purpose only and do not represent the actual size, features, specifications, fittings and furnishings. 7. The developer reserves the right to make revisions/ alterations, at its absolute discretion, without any liability whatsoever.

# 3 BEDROOM APARTMENT

TYPE E (with maid room + yard)

## TOTAL SALEABLE AREA

SUITE = 1,642.57 SQ.FT.

YARD = 539.66 SQ.FT.

TOTAL = 2,182.23 SQ.FT.

 UNIT

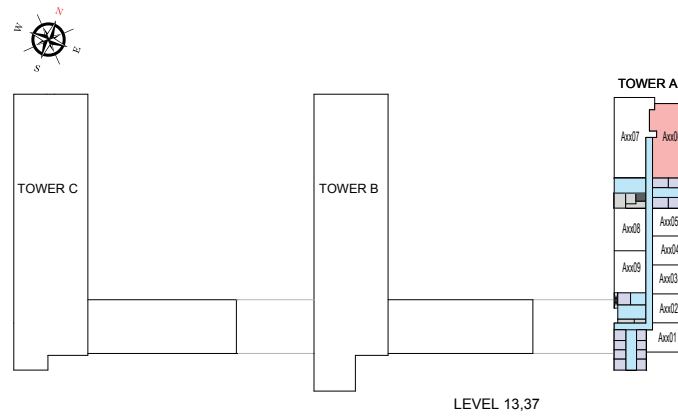

List of unit numbers with this unit plan:

## VIEWS

Ras Al Khor, Creek, Golf Course  
A1306, A3706

Disclaimer: 1. All dimensions are in metric, measured to wall finishes. 2. All materials, dimensions & drawings are approximate. 3. Information is subject to change without notice, at developer's absolute discretion. 4. Actual area may vary from the stated area. 5. Drawing are not to scale. 6. All images used are for illustrative purpose only and do not represent the actual size, features, specifications, fittings and furnishings. 7. The developer reserves the right to make revisions/ alterations, at its absolute discretion, without any liability whatsoever.

# 3 BEDROOM APARTMENT

## TYPE E (with maid room + yard) VARIANT 1

**TOTAL SALEABLE AREA**

SUITE = 1,642.57 SQ.FT.

YARD = 539.66 SQ.FT.

TOTAL = 2,182.23 SQ.FT.

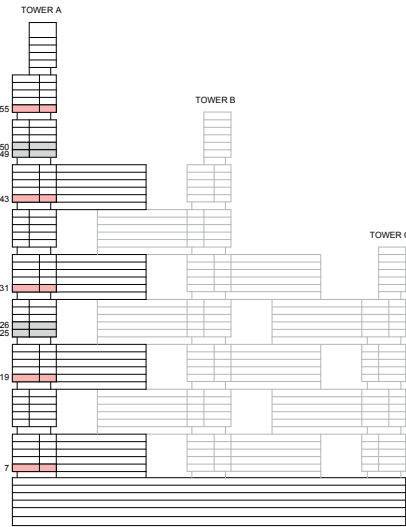

KEY ELEVATION

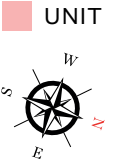

List of unit numbers with this unit plan:

### VIEWS

Downtown, Ras Al Khor, Creek, Golf Course, Amenities  
A707

Downtown, Ras Al Khor, Creek, Golf Course, Water Body, Amenities  
A1907

Downtown, Ras Al Khor, Creek, Golf Course, Water Body  
A3107, A4307, A5508

Disclaimer: 1. All dimensions are in metric, measured to wall finishes. 2. All materials, dimensions & drawings are approximate. 3. Information is subject to change without notice, at developer's absolute discretion. 4. Actual area may vary from the stated area. 5. Drawing are not to scale. 6. All images used are for illustrative purpose only and do not represent the actual size, features, specifications, fittings and furnishings. 7. The developer reserves the right to make revisions/ alterations, at its absolute discretion, without any liability whatsoever.

# 3 BEDROOM APARTMENT

## TYPE E (with maid room + yard) VARIANT 1

**TOTAL SALEABLE AREA**

SUITE = 1,642.57 SQ.FT.

YARD = 539.66 SQ.FT.

TOTAL = 2,182.23 SQ.FT.

■ UNIT

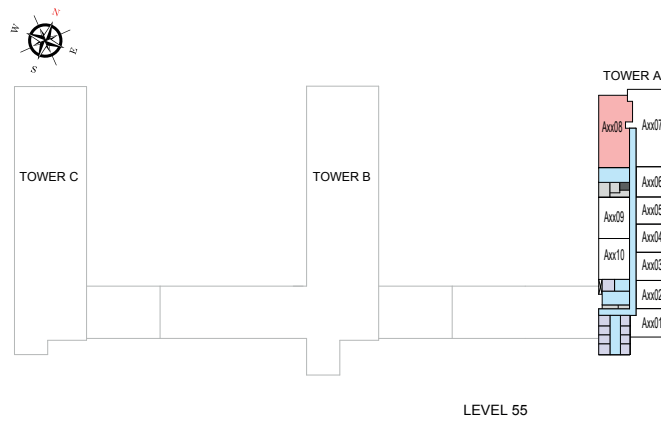
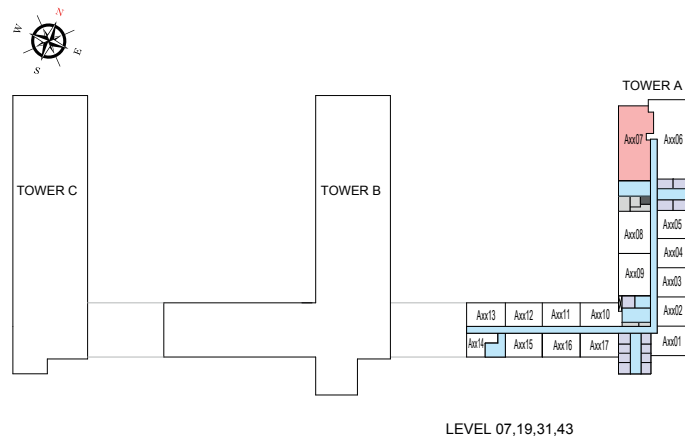

List of unit numbers with this unit plan:

### VIEWS

Downtown, Ras Al Khor, Creek, Golf Course, Amenities  
A707

Downtown, Ras Al Khor, Creek, Golf Course, Water Body, Amenities  
A1907

Downtown, Ras Al Khor, Creek, Golf Course, Water Body  
A3107, A4307, A5508

Disclaimer: 1. All dimensions are in metric, measured to wall finishes. 2. All materials, dimensions & drawings are approximate. 3. Information is subject to change without notice, at developer's absolute discretion. 4. Actual area may vary from the stated area. 5. Drawing are not to scale. 6. All images used are for illustrative purpose only and do not represent the actual size, features, specifications, fittings and furnishings. 7. The developer reserves the right to make revisions/ alterations, at its absolute discretion, without any liability whatsoever.

# 4 BEDROOM APARTMENT

TYPE A (with store room, maid room and powder room + balcony)

**TOTAL SALEABLE AREA**

SUITE = 2,080.88 SQ.FT.

BALCONY = 196.34 SQ.FT.

TOTAL = 2,277.22 SQ.FT.

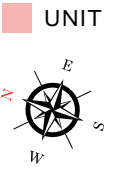
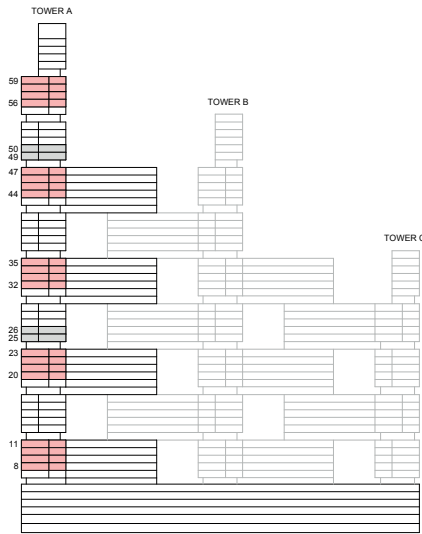

List of unit numbers with this unit plan:

## VIEWS

Downtown, Ras Al Khor, Creek, Golf Course, Water Body

A806, A906, A1006, A1106, A2006, A2106, A2206, A2306, A3206, A3306, A3406, A3506, A4406, A4506, A4606, A4706, A5607, A5707, A5807, A5907

Disclaimer: 1. All dimensions are in metric, measured to wall finishes. 2. All materials, dimensions & drawings are approximate. 3. Information is subject to change without notice, at developer's absolute discretion. 4. Actual area may vary from the stated area. 5. Drawing are not to scale. 6. All images used are for illustrative purpose only and do not represent the actual size, features, specifications, fittings and furnishings. 7. The developer reserves the right to make revisions/ alterations, at its absolute discretion, without any liability whatsoever.

# 4 BEDROOM APARTMENT

TYPE A (with store room, maid room and powder room + balcony)

**TOTAL SALEABLE AREA**

SUITE = 2,080.88 SQ.FT.

BALCONY = 196.34 SQ.FT.

TOTAL = 2,277.22 SQ.FT.

UNIT

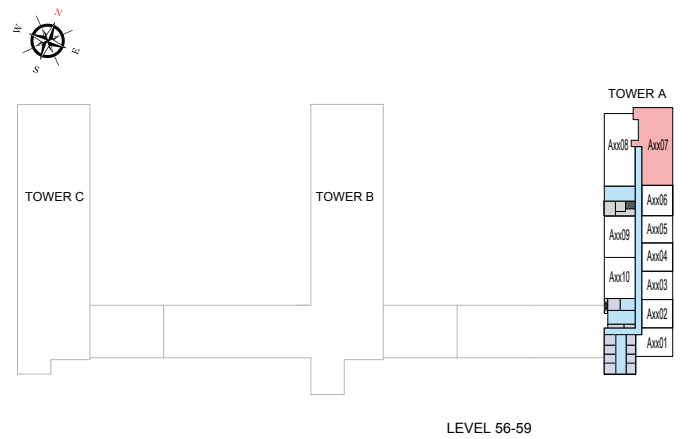
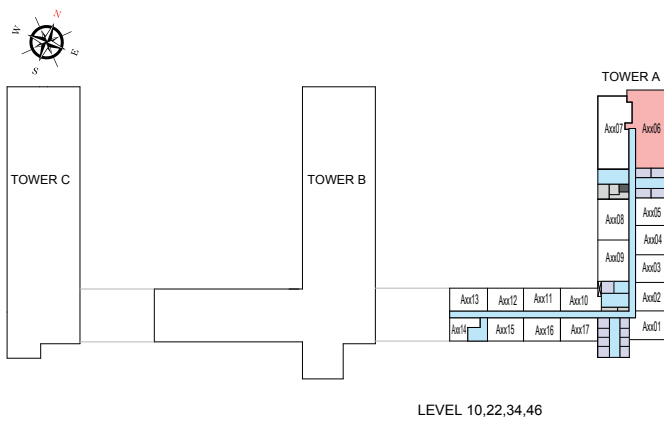
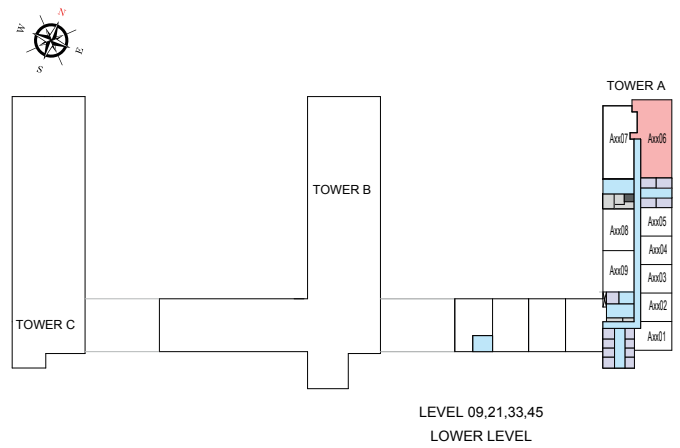
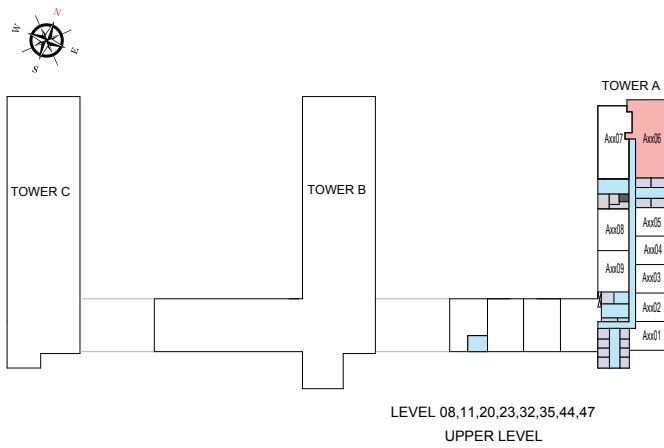

List of unit numbers with this unit plan:

## VIEWS

Downtown, Ras Al Khor, Creek, Golf Course, Water Body

A806, A906, A1006, A1106, A2006, A2106, A2206, A2306, A3206, A3306, A3406, A3506, A4406, A4506, A4606, A4706, A5607, A5707, A5807, A5907

Disclaimer: 1. All dimensions are in metric, measured to wall finishes. 2. All materials, dimensions & drawings are approximate. 3. Information is subject to change without notice, at developer's absolute discretion. 4. Actual area may vary from the stated area. 5. Drawing are not to scale. 6. All images used are for illustrative purpose only and do not represent the actual size, features, specifications, fittings and furnishings. 7. The developer reserves the right to make revisions/ alterations, at its absolute discretion, without any liability whatsoever.



# 4 BEDROOM APARTMENT

TYPE A (with store room, maid room and powder room + balcony) VARIANT 1

**TOTAL SALEABLE AREA**

SUITE = 2,080.88 SQ.FT.

BALCONY = 196.34 SQ.FT.

TOTAL = 2,277.22 SQ.FT.

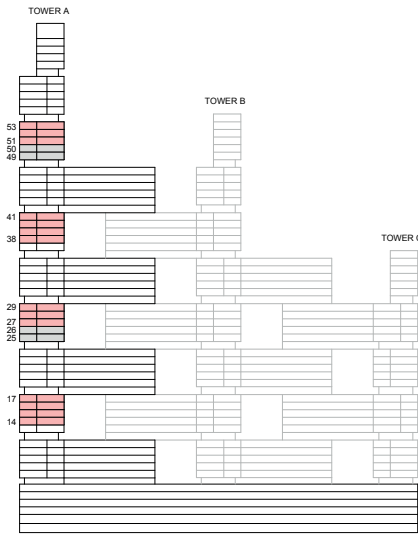

KEY ELEVATION



List of unit numbers with this unit plan:

## VIEWS

Downtown, Ras Al Khor, Creek, Golf Course, Water Body, Amenities

A1407, A1507, A1607, A1707

Downtown, Ras Al Khor, Creek, Golf Course, Water Body

A2707, A2807, A2907, A3807, A3907, A4007, A4107, A5108, A5208, A5308

Disclaimer: 1. All dimensions are in metric, measured to wall finishes. 2. All materials, dimensions & drawings are approximate. 3. Information is subject to change without notice, at developer's absolute discretion. 4. Actual area may vary from the stated area. 5. Drawing are not to scale. 6. All images used are for illustrative purpose only and do not represent the actual size, features, specifications, fittings and furnishings. 7. The developer reserves the right to make revisions/ alterations, at its absolute discretion, without any liability whatsoever.

# 4 BEDROOM APARTMENT

TYPE A (with store room, maid room and powder room + balcony) VARIANT 1

## TOTAL SALEABLE AREA

SUITE = 2,080.88 SQ.FT.

BALCONY = 196.34 SQ.FT.

TOTAL = 2,277.22 SQ.FT.

UNIT

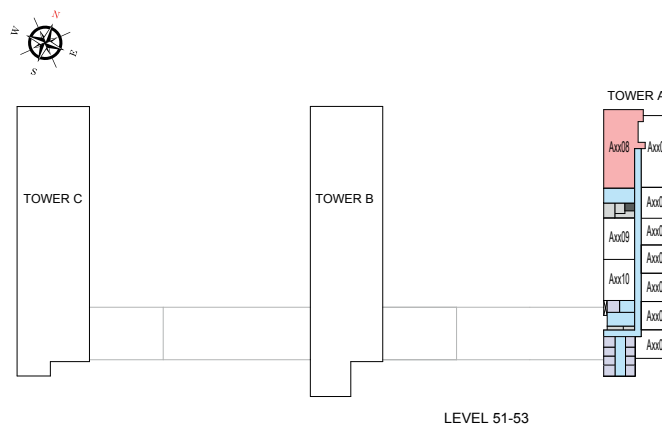
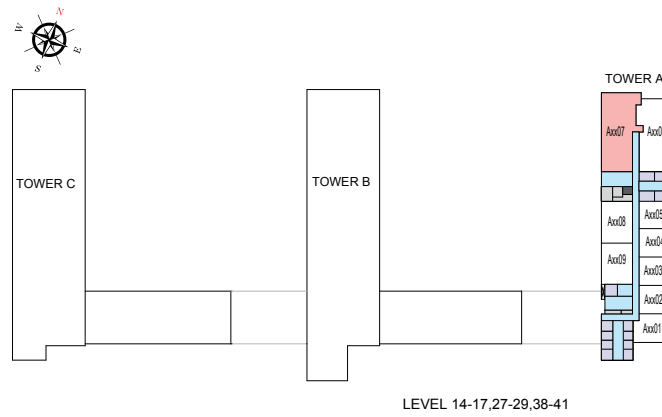

List of unit numbers with this unit plan:

## VIEWS

Downtown, Ras Al Khor, Creek, Golf Course, Water Body, Amenities

A1407, A1507, A1607, A1707

Downtown, Ras Al Khor, Creek, Golf Course, Water Body

A2707, A2807, A2907, A3807, A3907, A4007, A4107, A5108, A5208, A5308

Disclaimer: 1. All dimensions are in metric, measured to wall finishes. 2. All materials, dimensions & drawings are approximate. 3. Information is subject to change without notice, at developer's absolute discretion. 4. Actual area may vary from the stated area. 5. Drawing are not to scale. 6. All images used are for illustrative purpose only and do not represent the actual size, features, specifications, fittings and furnishings. 7. The developer reserves the right to make revisions/ alterations, at its absolute discretion, without any liability whatsoever.

# 4 BEDROOM APARTMENT

TYPE B (with store room, maid room and powder room + yard)

**TOTAL SALEABLE AREA**

SUITE = 2,084.43 SQ.FT.

YARD = 477.92 SQ.FT.

TOTAL = 2,562.35 SQ.FT.

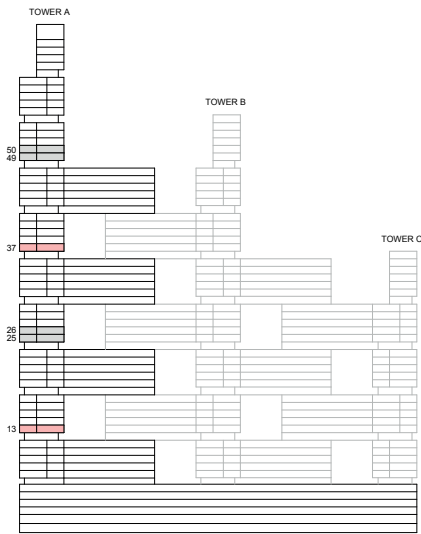

KEY ELEVATION



List of unit numbers with this unit plan:

## VIEWS

Downtown, Ras Al Khor, Creek, Golf Course, Water Body, Amenities

A1307

Downtown, Ras Al Khor, Creek, Golf Course, Water Body

A3707

Disclaimer: 1. All dimensions are in metric, measured to wall finishes. 2. All materials, dimensions & drawings are approximate. 3. Information is subject to change without notice, at developer's absolute discretion. 4. Actual area may vary from the stated area. 5. Drawing are not to scale. 6. All images used are for illustrative purpose only and do not represent the actual size, features, specifications, fittings and furnishings. 7. The developer reserves the right to make revisions/ alterations, at its absolute discretion, without any liability whatsoever.

# 4 BEDROOM APARTMENT

TYPE B (with store room, maid room and powder room + yard)

## TOTAL SALEABLE AREA

SUITE = 2,084.43 SQ.FT.

YARD = 477.92 SQ.FT.

TOTAL = 2,562.35 SQ.FT.

 UNIT

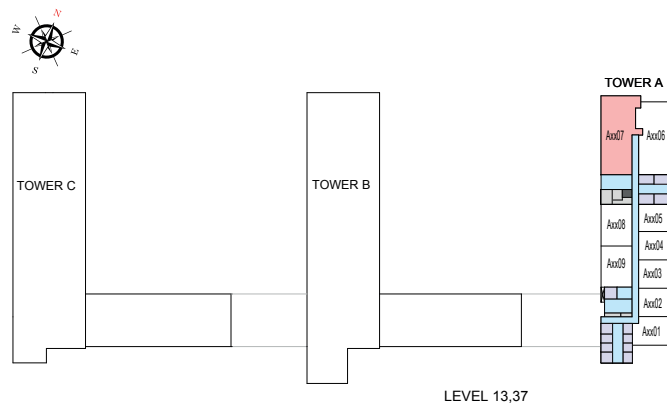

List of unit numbers with this unit plan:

## VIEWS

Downtown, Ras Al Khor, Creek, Golf Course, Water Body, Amenities

A1307

Downtown, Ras Al Khor, Creek, Golf Course, Water Body

A3707

Disclaimer: 1. All dimensions are in metric, measured to wall finishes. 2. All materials, dimensions & drawings are approximate. 3. Information is subject to change without notice, at developer's absolute discretion. 4. Actual area may vary from the stated area. 5. Drawing are not to scale. 6. All images used are for illustrative purpose only and do not represent the actual size, features, specifications, fittings and furnishings. 7. The developer reserves the right to make revisions/ alterations, at its absolute discretion, without any liability whatsoever.

# 4 BEDROOM APARTMENT

TYPE B (with store room, maid room and powder room + yard) VARIANT 1

**TOTAL SALEABLE AREA**

SUITE = 2,084.43 SQ.FT.

YARD = 477.92 SQ.FT.

TOTAL = 2,562.35 SQ.FT.

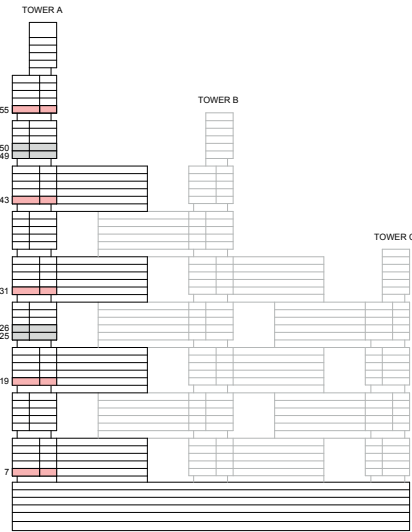

KEY ELEVATION

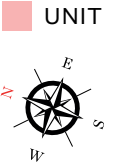

List of unit numbers with this unit plan:

## VIEWS

Downtown, Ras Al Khor, Creek, Golf Course  
A706

Downtown, Ras Al Khor, Creek, Golf Course, Water Body  
A1906, A3106, A4306, A5507

Disclaimer: 1. All dimensions are in metric, measured to wall finishes. 2. All materials, dimensions & drawings are approximate. 3. Information is subject to change without notice, at developer's absolute discretion. 4. Actual area may vary from the stated area. 5. Drawing are not to scale. 6. All images used are for illustrative purpose only and do not represent the actual size, features, specifications, fittings and furnishings. 7. The developer reserves the right to make revisions/ alterations, at its absolute discretion, without any liability whatsoever.

# 4 BEDROOM APARTMENT

TYPE B (with store room, maid room and powder room + yard) VARIANT 1

**TOTAL SALEABLE AREA**

SUITE = 2,084.43 SQ.FT.

YARD = 477.92 SQ.FT.

TOTAL = 2,562.35 SQ.FT.

 UNIT

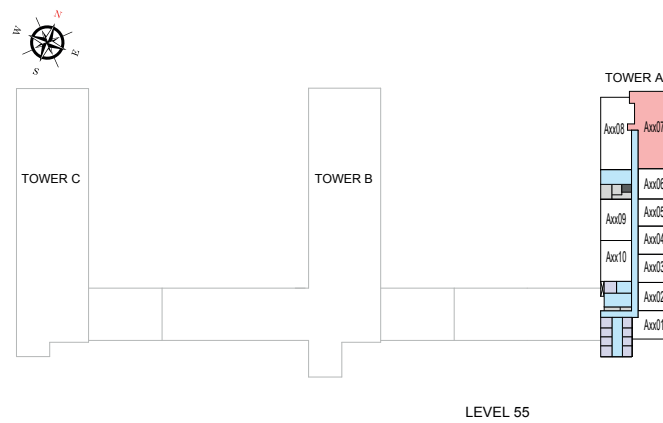
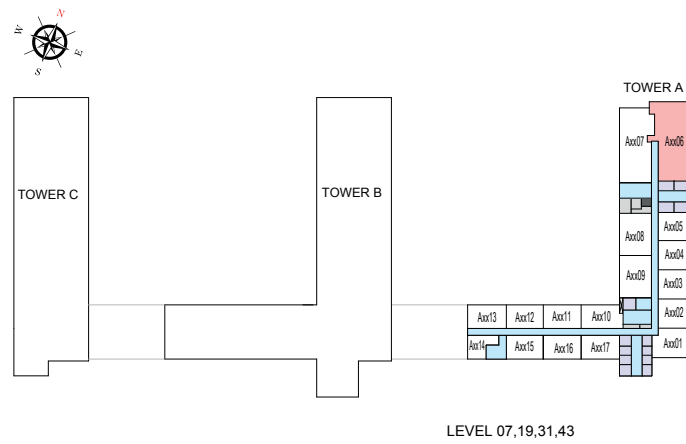

List of unit numbers with this unit plan:

## VIEWS

Downtown, Ras Al Khor, Creek, Golf Course  
A706

Downtown, Ras Al Khor, Creek, Golf Course, Water Body  
A1906, A3106, A4306, A5507

Disclaimer: 1. All dimensions are in metric, measured to wall finishes. 2. All materials, dimensions & drawings are approximate. 3. Information is subject to change without notice, at developer's absolute discretion. 4. Actual area may vary from the stated area. 5. Drawing are not to scale. 6. All images used are for illustrative purpose only and do not represent the actual size, features, specifications, fittings and furnishings. 7. The developer reserves the right to make revisions/ alterations, at its absolute discretion, without any liability whatsoever.

# 2 BEDROOM DUPLEX APARTMENT

TYPE A (with store room, maid room and powder room + balcony)

**TOTAL SALEABLE AREA**

SUITE = 1,701.76 SQ.FT.

BALCONY = 178.96 SQ.FT.

TOTAL = 1,880.72 SQ.FT.

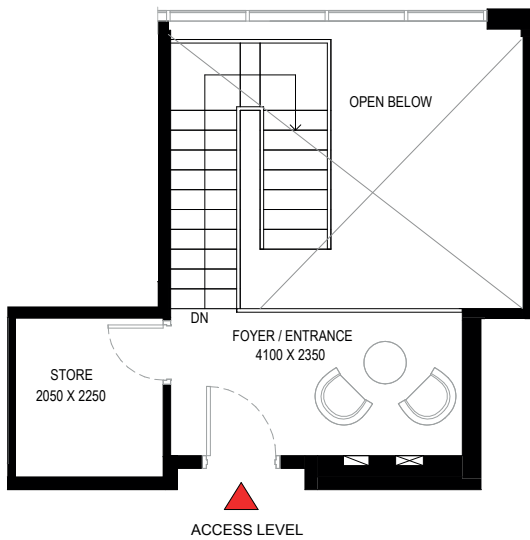
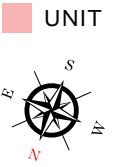
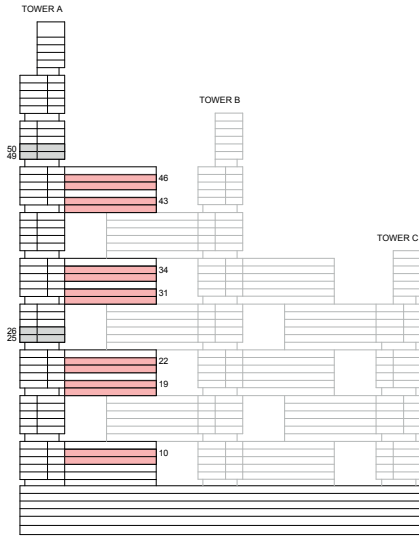

List of unit numbers with this unit plan:

## VIEWS

Ras Al Khor, Golf Course, Amenities  
A1014, A1914, A2214

Ras Al Khor, Golf Course  
A3114, A3414, A4314, A4614

LOWER LEVEL

Disclaimer: 1. All dimensions are in metric, measured to wall finishes. 2. All materials, dimensions & drawings are approximate. 3. Information is subject to change without notice, at developer's absolute discretion. 4. Actual area may vary from the stated area. 5. Drawing are not to scale. 6. All images used are for illustrative purpose only and do not represent the actual size, features, specifications, fittings and furnishings. 7. The developer reserves the right to make revisions/ alterations, at its absolute discretion, without any liability whatsoever.

# 2 BEDROOM DUPLEX APARTMENT

TYPE A (with store room, maid room and powder room + balcony)

**TOTAL SALEABLE AREA**

SUITE = 1,701.76 SQ.FT.

BALCONY = 178.96 SQ.FT.

TOTAL = 1,880.72 SQ.FT.

 UNIT

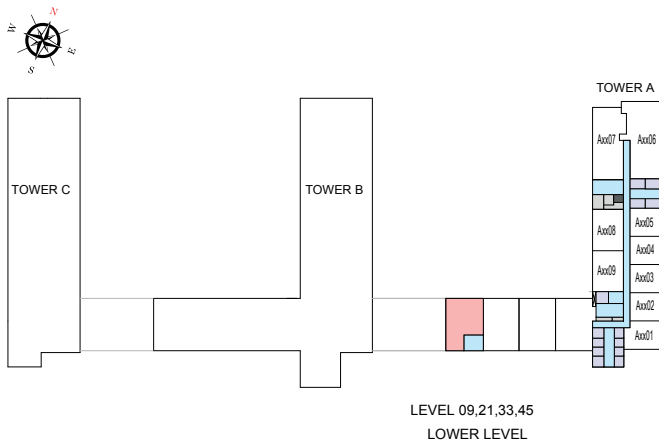
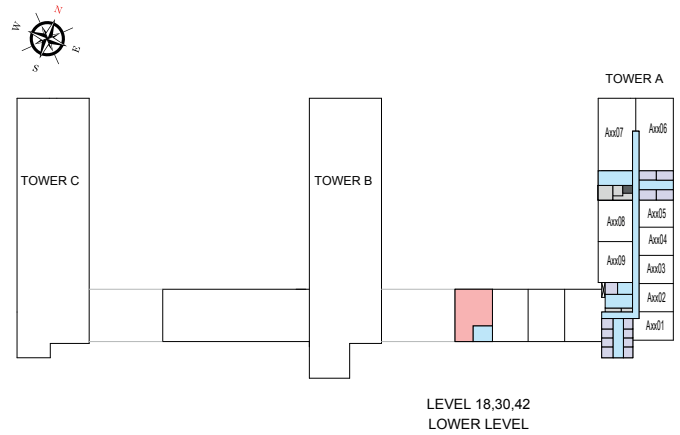
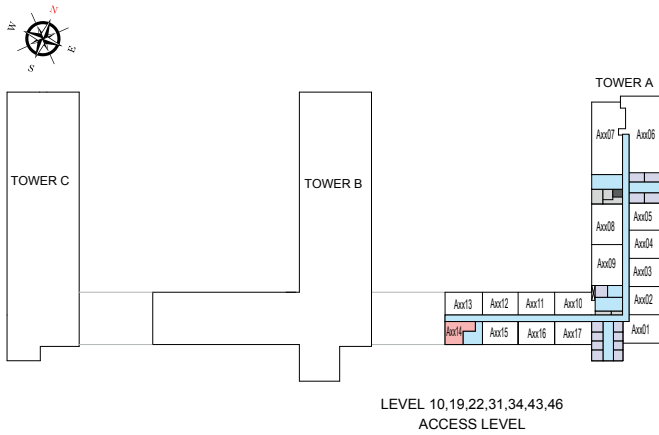

List of unit numbers with this unit plan:

## VIEWS

Ras Al Khor, Golf Course, Amenities

A1014, A1914, A2214

Ras Al Khor, Golf Course

A3114, A3414, A4314, A4614

Disclaimer: 1. All dimensions are in metric, measured to wall finishes. 2. All materials, dimensions & drawings are approximate. 3. Information is subject to change without notice, at developer's absolute discretion. 4. Actual area may vary from the stated area. 5. Drawing are not to scale. 6. All images used are for illustrative purpose only and do not represent the actual size, features, specifications, fittings and furnishings. 7. The developer reserves the right to make revisions/ alterations, at its absolute discretion, without any liability whatsoever.



# 4 BEDROOM DUPLEX APARTMENT

## TYPE A (with maid room and powder room + balcony)

**TOTAL SALEABLE AREA**

SUITE = 2,176.53 SQ.FT.

BALCONY = 176.25 SQ.FT.

TOTAL = 2,352.78 SQ.FT.

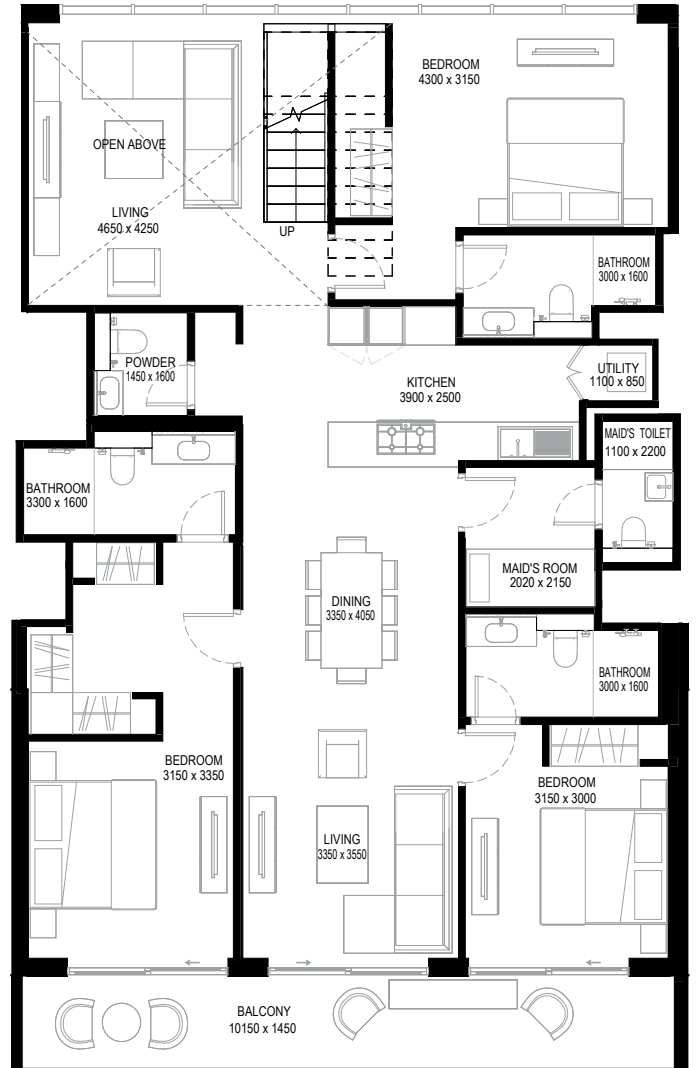
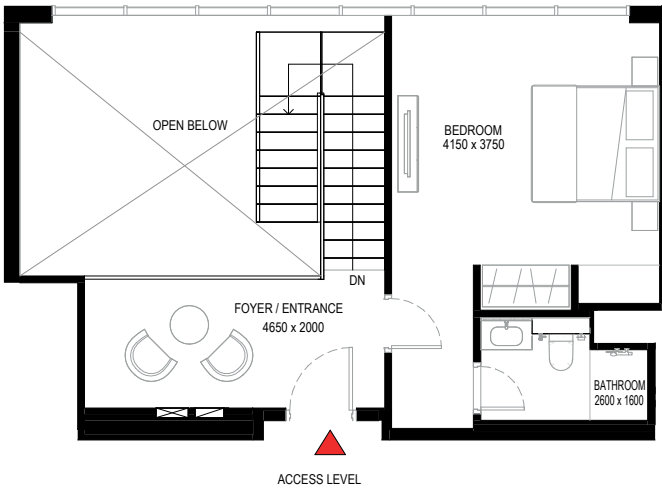
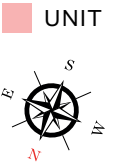
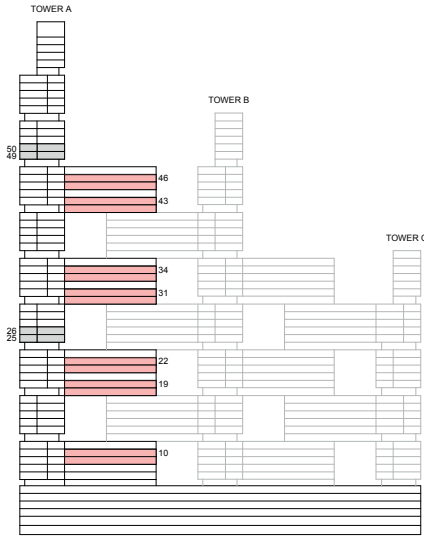

List of unit numbers with this unit plan:

### VIEWS

Ras Al Khor, Golf Course, Amenities  
A1015, A1915, A2215

Ras Al Khor, Golf Course  
A3115, A3415, A4315, A4615

LOWER LEVEL

Disclaimer: 1. All dimensions are in metric, measured to wall finishes. 2. All materials, dimensions & drawings are approximate. 3. Information is subject to change without notice, at developer's absolute discretion. 4. Actual area may vary from the stated area. 5. Drawing are not to scale. 6. All images used are for illustrative purpose only and do not represent the actual size, features, specifications, fittings and furnishings. 7. The developer reserves the right to make revisions/ alterations, at its absolute discretion, without any liability whatsoever.

**4 BEDROOM DUPLEX APARTMENT**  
**TYPE A (with maid room and powder room + balcony)**

**TOTAL SALEABLE AREA**

SUITE = 2,176.53 SQ.FT.

BALCONY = 176.25 SQ.FT.

TOTAL = 2,352.78 SQ.FT.

 UNIT

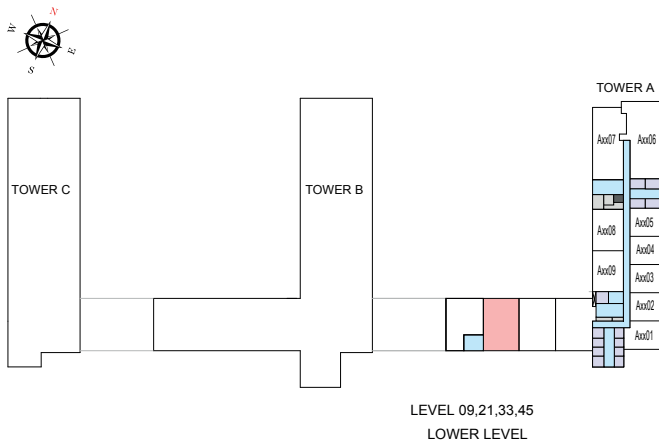
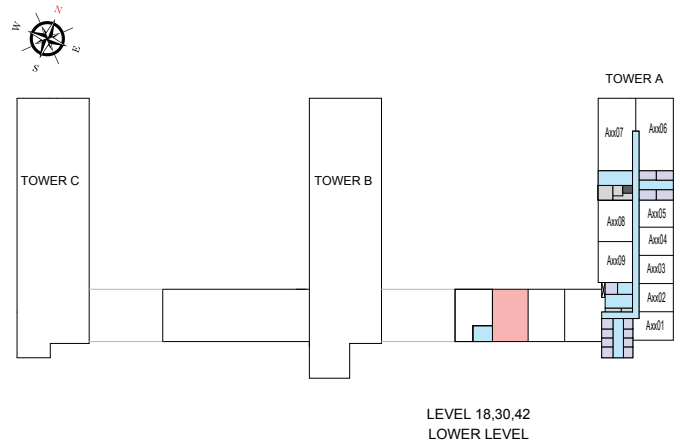
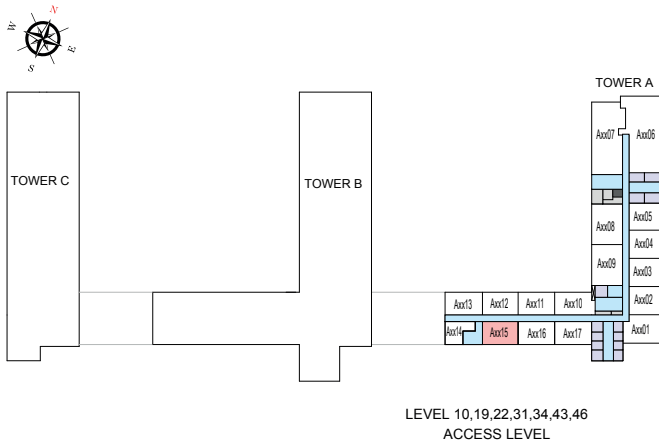

List of unit numbers with this unit plan:

**VIEWS**

Ras Al Khor, Golf Course, Amenities  
A1015, A1915, A2215

Ras Al Khor, Golf Course  
A3115, A3415, A4315, A4615

Disclaimer: 1. All dimensions are in metric, measured to wall finishes. 2. All materials, dimensions & drawings are approximate. 3. Information is subject to change without notice, at developer's absolute discretion. 4. Actual area may vary from the stated area. 5. Drawing are not to scale. 6. All images used are for illustrative purpose only and do not represent the actual size, features, specifications, fittings and furnishings. 7. The developer reserves the right to make revisions/ alterations, at its absolute discretion, without any liability whatsoever.

# 4 BEDROOM DUPLEX APARTMENT

TYPE A (with maid room and powder room + balcony) VARIANT 1

**TOTAL SALEABLE AREA**

SUITE = 2,172.85 SQ.FT.

BALCONY = 176.25 SQ.FT.

TOTAL = 2,349.10 SQ.FT.

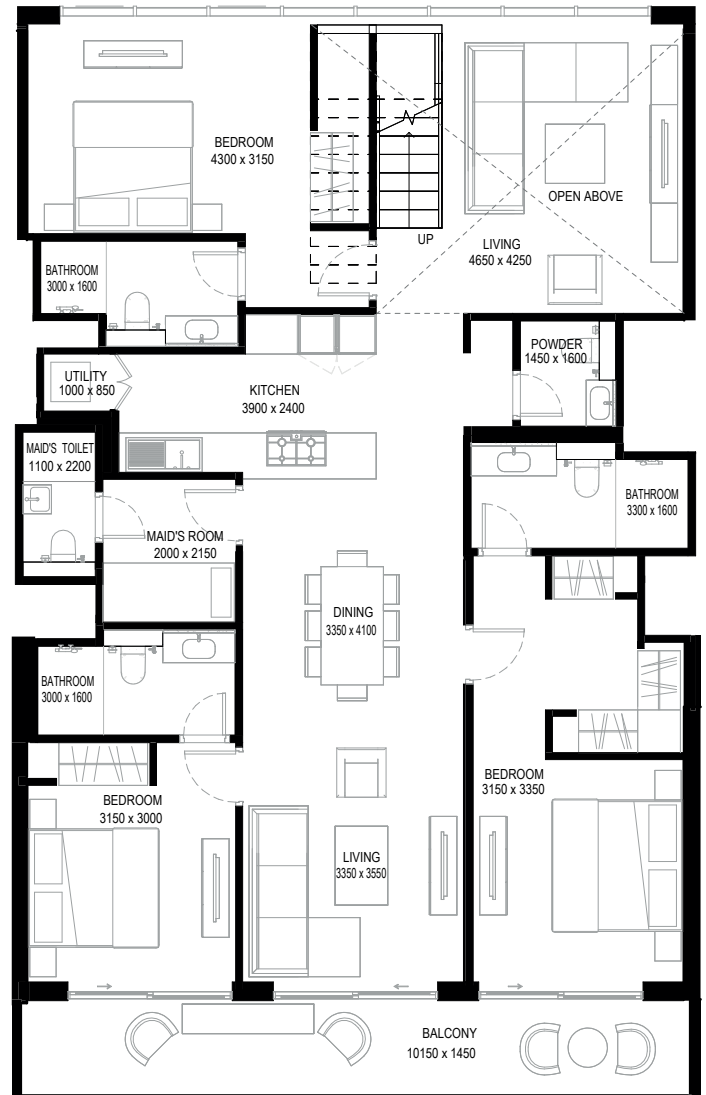
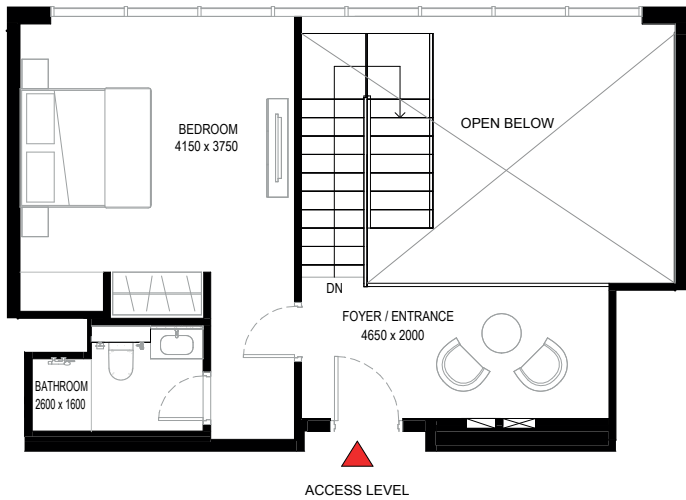
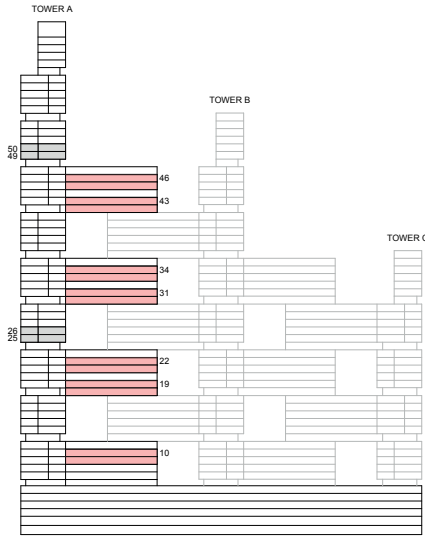

List of unit numbers with this unit plan:

## VIEWS

Ras Al Khor, Golf Course, Amenities  
A1016, A1916, A2216

Ras Al Khor, Golf Course  
A3116, A3416, A4316, A4616

Disclaimer: 1. All dimensions are in metric, measured to wall finishes. 2. All materials, dimensions & drawings are approximate. 3. Information is subject to change without notice, at developer's absolute discretion. 4. Actual area may vary from the stated area. 5. Drawing are not to scale. 6. All images used are for illustrative purpose only and do not represent the actual size, features, specifications, fittings and furnishings. 7. The developer reserves the right to make revisions/ alterations, at its absolute discretion, without any liability whatsoever.

# 4 BEDROOM DUPLEX APARTMENT

TYPE A (with maid room and powder room + balcony) VARIANT 1

**TOTAL SALEABLE AREA**

SUITE = 2,172.85 SQ.FT.

BALCONY = 176.25 SQ.FT.

TOTAL = 2,349.10 SQ.FT.

 UNIT

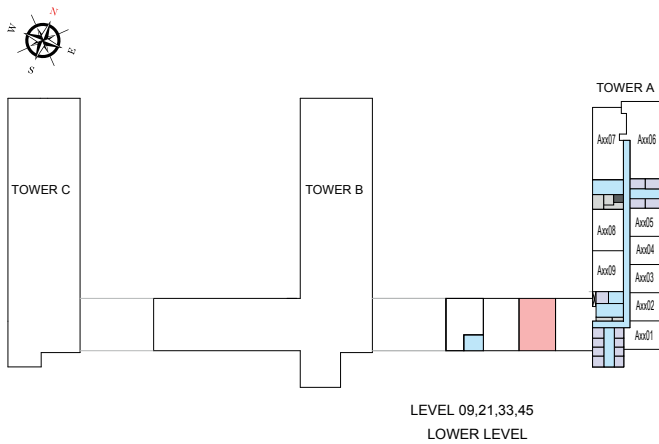
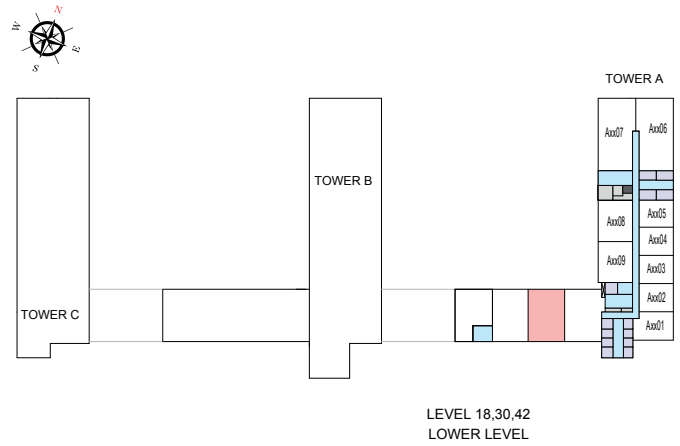
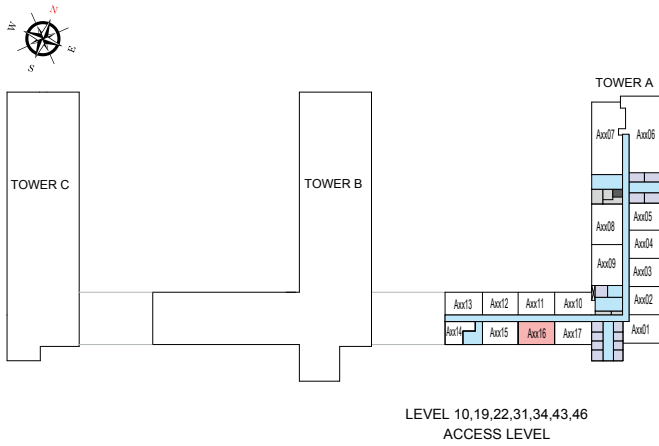

List of unit numbers with this unit plan:

## VIEWS

Ras Al Khor, Golf Course, Amenities

A1016, A1916, A2216

Ras Al Khor, Golf Course

A3116, A3416, A4316, A4616

Disclaimer: 1. All dimensions are in metric, measured to wall finishes. 2. All materials, dimensions & drawings are approximate. 3. Information is subject to change without notice, at developer's absolute discretion. 4. Actual area may vary from the stated area. 5. Drawing are not to scale. 6. All images used are for illustrative purpose only and do not represent the actual size, features, specifications, fittings and furnishings. 7. The developer reserves the right to make revisions/ alterations, at its absolute discretion, without any liability whatsoever.

# 4 BEDROOM DUPLEX APARTMENT

## TYPE A1 (with maid room and powder room + balcony)

**TOTAL SALEABLE AREA**

SUITE = 2,227.74 SQ.FT.

BALCONY = 173.33 SQ.FT.

TOTAL = 2,401.07 SQ.FT.

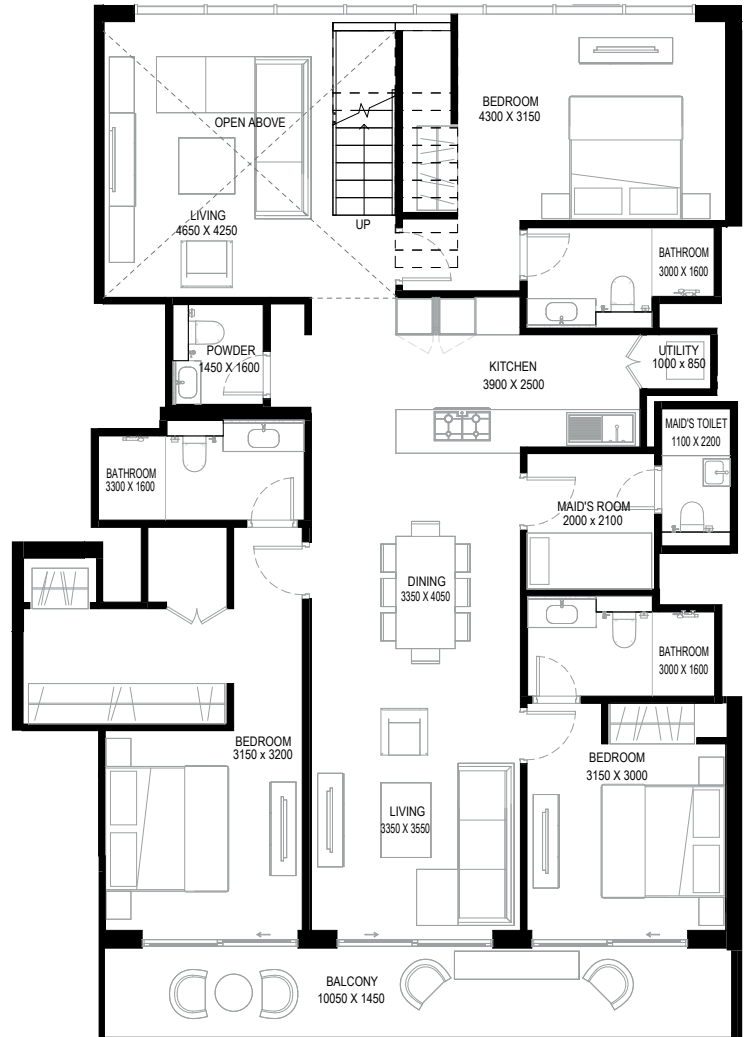
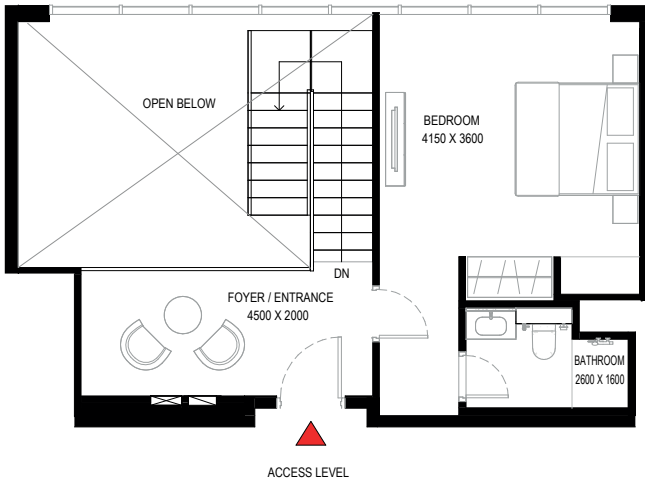
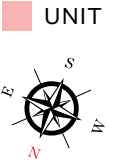
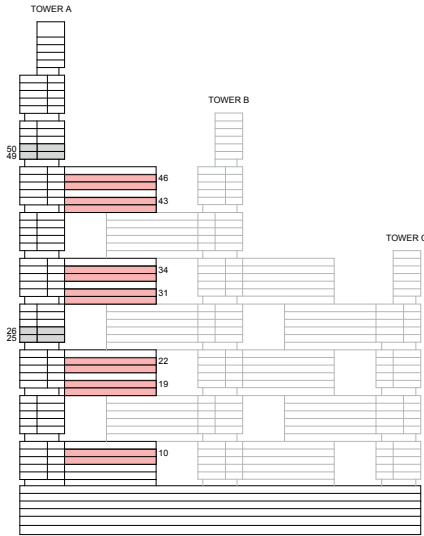

List of unit numbers with this unit plan:

### VIEWS

Ras Al Khor, Golf Course, Amenities  
A1017, A1917, A2217

Ras Al Khor, Golf Course  
A3117, A3417, A4317, A4617

LOWER LEVEL

Disclaimer: 1. All dimensions are in metric, measured to wall finishes. 2. All materials, dimensions & drawings are approximate. 3. Information is subject to change without notice, at developer's absolute discretion. 4. Actual area may vary from the stated area. 5. Drawing are not to scale. 6. All images used are for illustrative purpose only and do not represent the actual size, features, specifications, fittings and furnishings. 7. The developer reserves the right to make revisions/ alterations, at its absolute discretion, without any liability whatsoever.

**4 BEDROOM DUPLEX APARTMENT**  
**TYPE A1 (with maid room and powder room + balcony)**

**TOTAL SALEABLE AREA**

SUITE = 2,227.74 SQ.FT.  
 BALCONY = 173.33 SQ.FT.  
 TOTAL = 2,401.07 SQ.FT.

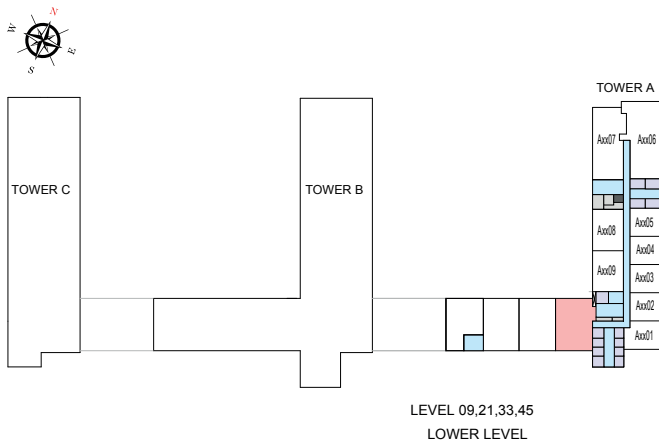
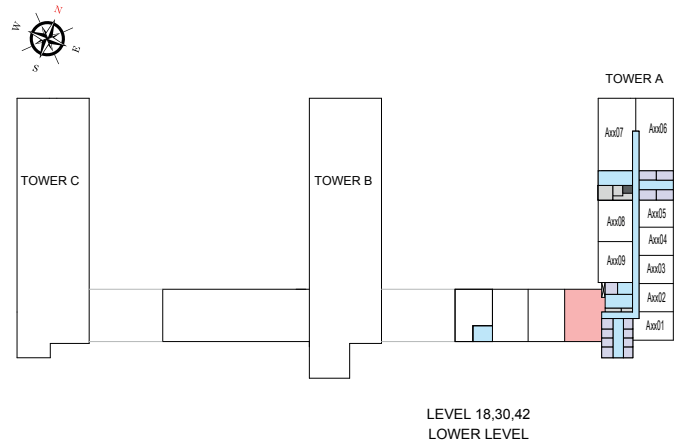
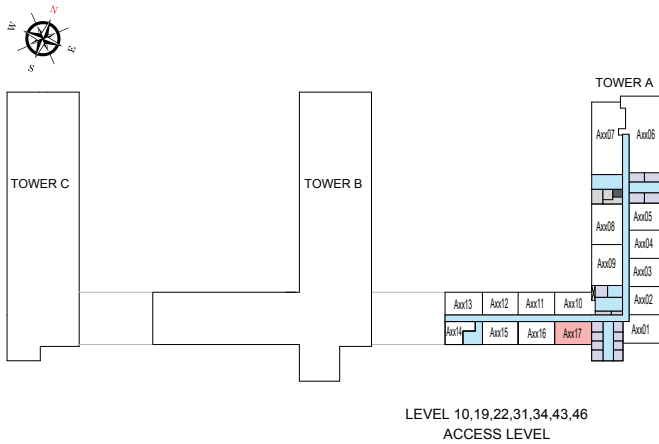

List of unit numbers with this unit plan:

**VIEWS**

Ras Al Khor, Golf Course, Amenities  
 A1017, A1917, A2217

Ras Al Khor, Golf Course  
 A3117, A3417, A4317, A4617

Disclaimer: 1. All dimensions are in metric, measured to wall finishes. 2. All materials, dimensions & drawings are approximate. 3. Information is subject to change without notice, at developer's absolute discretion. 4. Actual area may vary from the stated area. 5. Drawing are not to scale. 6. All images used are for illustrative purpose only and do not represent the actual size, features, specifications, fittings and furnishings. 7. The developer reserves the right to make revisions/ alterations, at its absolute discretion, without any liability whatsoever.



SOBHA ONE

SOBHA  
REALTY